

Wind-Protection Netting

Basics	B288 - B290
Fixed Systems	B291 - B293
Bayscreen - Clip-On Screen	B294 - B295
Rollerscreen	B296 - B297
Rapid Rollerdoor	B298 - B299
Electric Rollerdoor	B300 - B301
Agridoor	B302 - B307
Trackscreen	B308 - B309
Maxidoor	B310 - B311
Ventilation Systems	B312 - B317
Tube Ventilation Vent Tube	B318 - B319
PVC Strip Doors, Stockshades	B320 - B321





Fresh air for healthy animals

Well-ventilated buildings greatly increase animal health and hygiene. PATURA wind protection systems ensure natural ventilation conditions. The mesh material is suitable for all weather conditions. It reduces the wind speed by up to 82 % (wind reduction factor) and offers gentle ventilation of the building without draughts.

Heat build-up = Stress

A cow gives off up to 10 litres of water vapour into the buildings air per day. This, together with the other condensing water, leads to stress in the animals if the ventilation is inadequate. Heat and damp lead to problems in fertility and feed consumption in high-performance animals.

Signs of a poorly-ventilated building

A poorly or insufficiently ventilated building causes vapour, condensation and a smell of ammonia. Thus, the animals, their straw and the buildings themselves become damp. Combined with draughts, this soon leads to sickness in the animals and damages in the building itself.

The usage of wind protection and ventilation systems helps to avoid environmental health problems particularly respiratory diseases.



PATURA wind protection systems offer 3 important advantages for stress-free and healthy animals

Advantage 1: Fresh air without draughts

Advantage 2: Dry conditions

Advantage 3: Natural light

Even in buildings PATURA wind-protection systems offer the animals many of the advantages of life in the open air. **Good ventilation by high air flow, dry conditions and plenty of light are a guarantee for ideal climatic conditions without draught.**

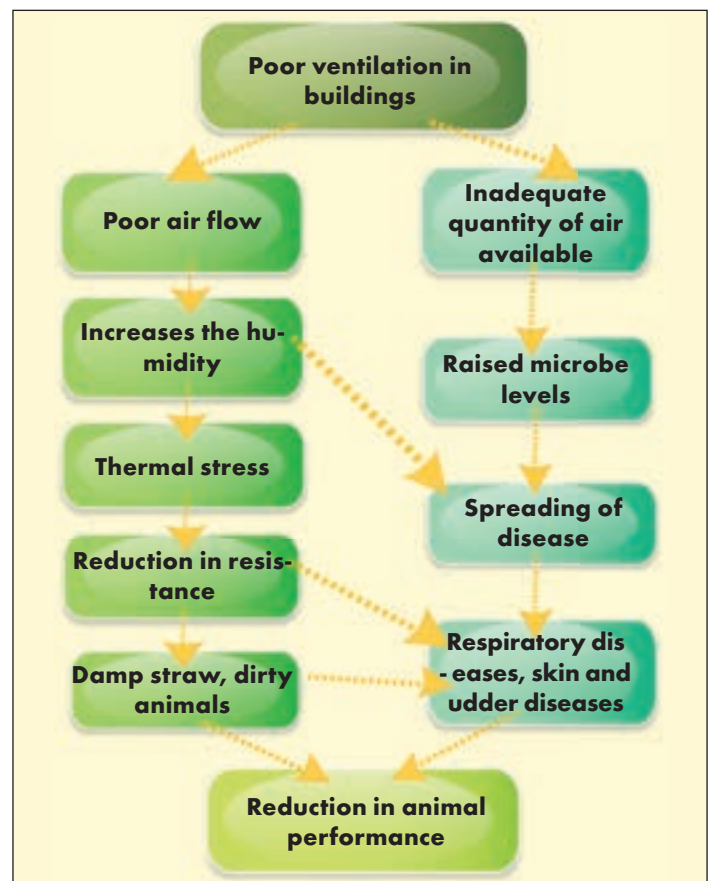

Natural ventilation in stables

Air volume

In order to ensure an adequate and reliable exchange of air, a certain volume of air, depending on the type and size of animals, is a prerequisite.

Per animal this is:

Dairy cow, suckler cow:	25 - 35 m ³ /animal
Ewe with 1 lamb:	5 - 10 m ³ /animal
Large horse:	30 - 40 m ³ /animal

Air entry surface area and air exit surface area

Air renewal is ensured through the establishment of openings with adequate surface area. It is important always to consider air entry and air exit areas together, in that the air entry area must be at least twice the size of the exit one. The following free areas are necessary when considering a height differential of 3 m between air entry and air exit:

	Entry surface	Exit surface
Dairy cow, large horse	0.24 - 0.30 m ² /animal	0.12 - 0.15 m ² /animal
Sheep	0.06 - 0.08 m ² /animal	0.03 - 0.04 m ² /animal



Wind protection systems offer visually superior building fronts with an optimum indoor environment

Assessment of wind protection netting

Various technical properties are important for assessing the effectiveness of wind protection and ventilation systems. The number, the size and the type of opening, as well as the choice of the basic material, have a decisive influence on wind-protection and air transmission.

Permeability

Permeability 'P' shows the ratio of opening in the mesh in relation to the overall mesh surface.

$$P = \frac{\text{surface area of the openings}}{\text{total surface area}} \times 100 \%$$

Wind reduction factor

The wind reduction factor 'E' is calculated as:

$$E = \left(1 - \frac{\text{wind speed behind the mesh}}{\text{wind speed in front of the mesh}} \right) \times 100 \%$$

Example: Wind speed of 100 km/h in front of the special mesh = 40 km/h behind it

Air transit factor

The air transit factor 'CM' gives the relationship between a net-covered surface and a surface with free air entry, for the same air transit.

For the same air transit: Free surface x CM = Net surface

Example: Opening of 1 m² => with special mesh 1.8 m²
=> with high-performance mesh 6.0 m²

The correct building ventilation system to meet your demands

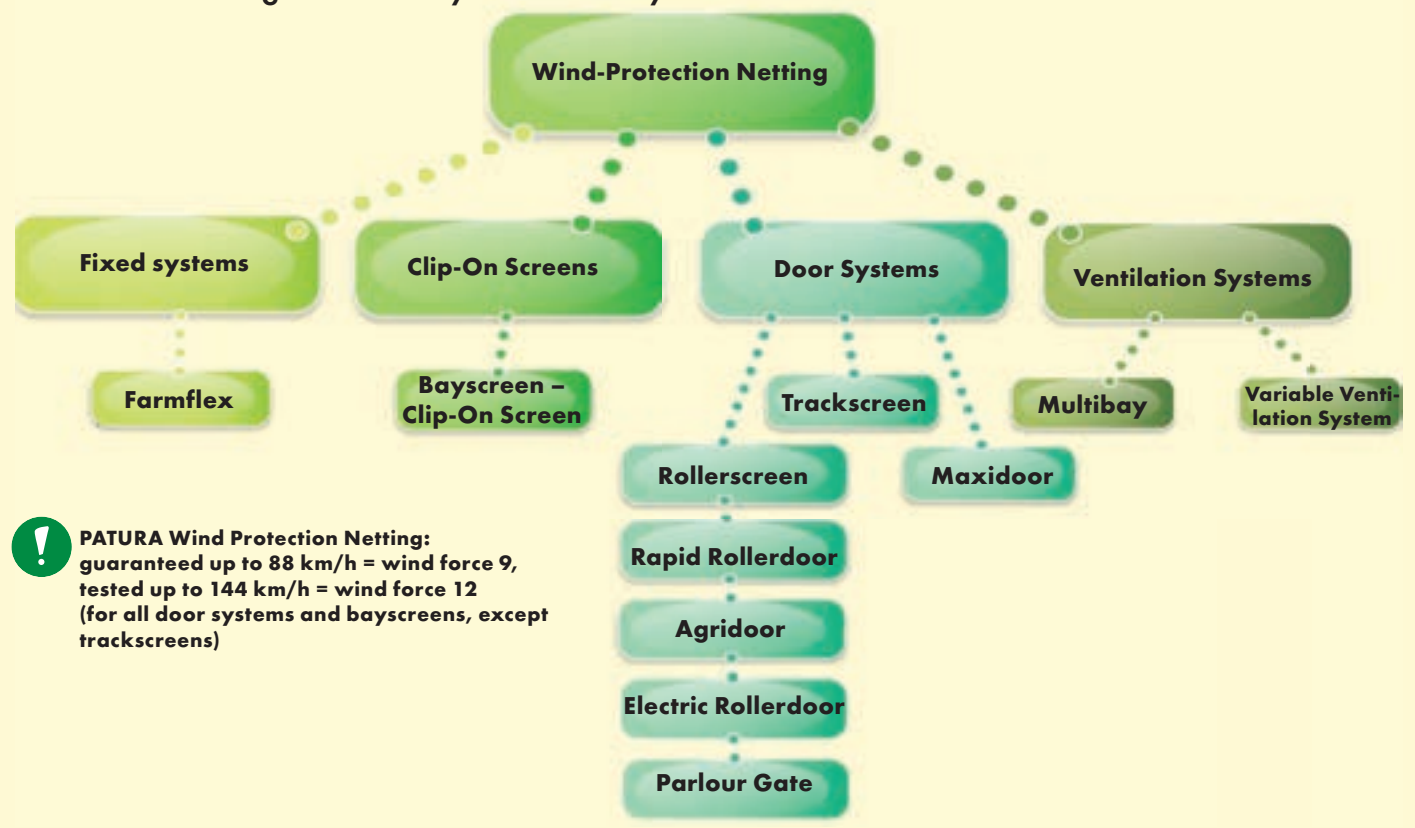

Wind-Protection Netting

PATURA wind protection netting consists of PVC coated polyester of flat woven thread in cross weave. All cross-over points are firmly bonded together. The material is UV stabilised, antistatic, rot-resistant, tear-resistant, non-toxic and fire retardant as per National Fire Protection Association Hazard Rating B1.

The PATURA warranty comprises a 24-months full warranty for all wind protection netting systems, an extended 3-year warranty for motors and control systems, as well as a graduated 10-year warranty for UV-stabilisation.

We have 3 different mesh types and one type of solid material:

Special Mesh

Single strand weave. The ideal wind protection netting with high level of air flow. Not directly beside animals



High Performance Mesh

Double strand weave. The ideal netting for wind protection e.g., when animals lie directly beside the net, and good protection against driving rain



Bird Net

Protects the air exit surface area or the completely opened ventilation systems against invading birds. Mesh size 24 x 17 mm



Solid Material

To completely and hermetically seal openings. Available for door systems and ventilation systems.



Fixed system with aluminium rails



Fixed system with kador profile on top and laid-flat pocket at the bottom. Tensioning via steel tubing (in the laid-flat pocket) and ratchets

Product	Colour	Material	Tensile strength	Permeability	Wind reduction capability	Air transit factor	Weight
Special mesh	green/brown/white/beige/black/grey/blue/red	PVC coated polyester	3.3 t/m	25 %	60 %	1.8	250 g/m ²
High performance mesh	green/black/grey	PVC coated polyester	4.0 t/m	10 %	82 %	6.0	460 g/m ²
Bird net	black	PVC coated polyester	-	-	0 %	1	-
Solid material	green/grey/white/beige/brown/blue/white translucent/green translucent/black translucent	PVC coated polyester	4.2 t/m	0 %	100 %	-	680 g/m ² 500 g/m ²

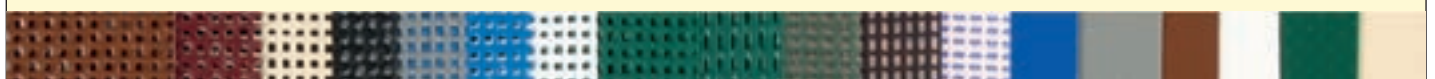

Fixed Installation Wind-Protection System

A fixed wind protection and ventilation system offers the optimum possibility of allowing fresh air and light into the insides of buildings, while leaving wind, draughts and rain on the outside.

It offers the most economic solution for maintaining an optimum stall climate. Offering simple and safe installation by means of clip-together aluminium rails.

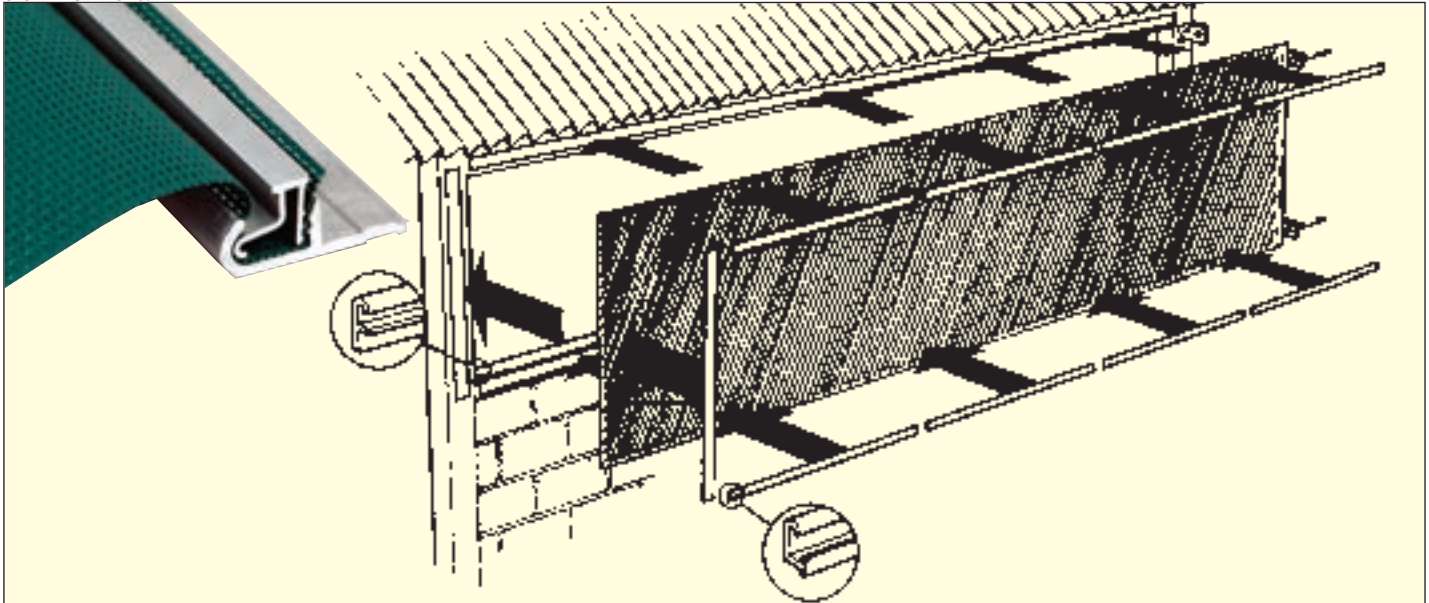

Farmflex is easy to attach to the building with the help of clip-together aluminium rails: screw the aluminium base rail to the building every 50 cm - insert net and tension - press in the clip rail

Installation tip: allow the net to overlap slightly - it can then be easily removed again



Fixed installation wind-protection systems offer bright buildings, cost effective building structures and attractive building facades



With aluminium profile fixed wind-protection systems for optimum building ventilation and brightness in the stable



Fixed system with aluminium profile and tensioning facility

Establishing the dimensions for various mounting options

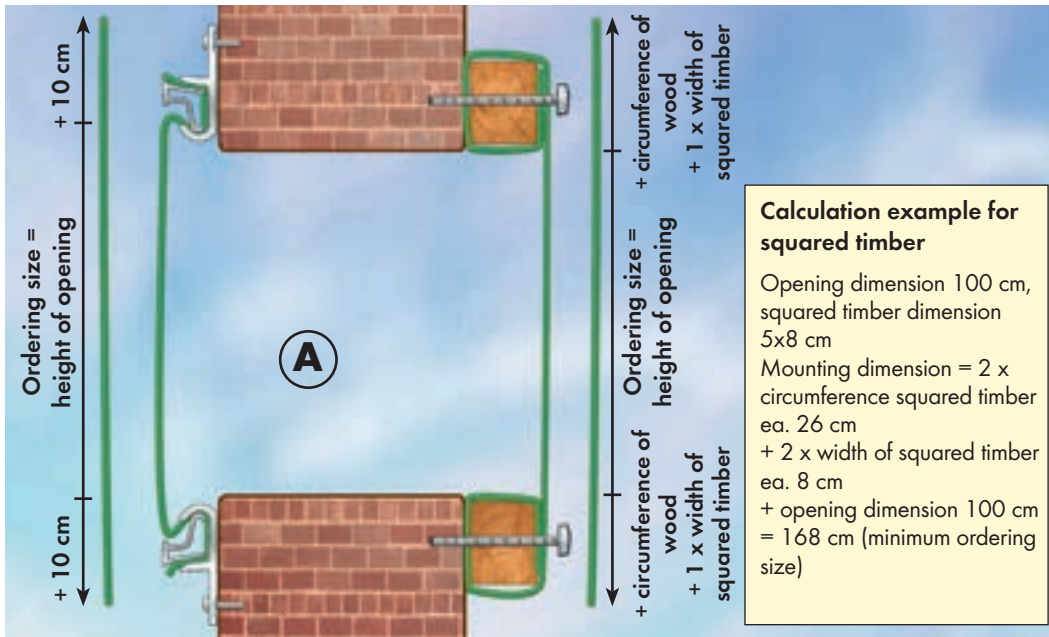

A) Mounting with aluminium rails or squared timber
Establish the dimensions of the surface to be covered and add the additional material requirement for the installation.

Mounting with aluminum rails: Order dimension = size of opening + at least 10 cm (per side)

Mounting with squared timber: Order dimension = size of opening + mounting dimension (per side)

Mounting dimension = 1 x circumference of squared timber + 1 x width of squared timber

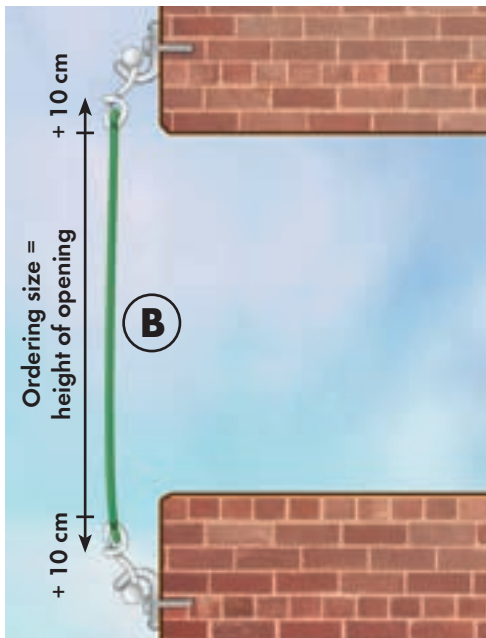

B) Mounting with eyelets (Ø 16 mm) at a pitch of 25 cm or 50 cm (optional) and edge reinforcement

Mounting in front of opening: ordering size = size of opening + 10 cm on each side

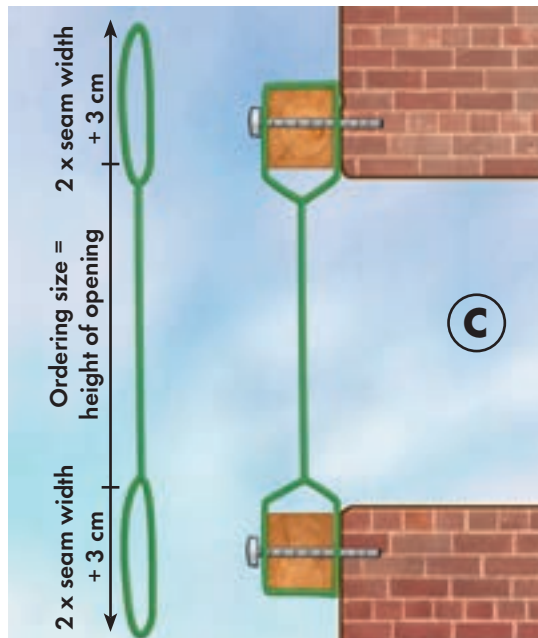

C) Mounting with welded laid-flat pocket

Mounting in front of opening:

ordering dimension = size of opening + 2 x laid-flat pocket widths + 3 cm (welding width) per each side
To establish the laid-flat pocket dimension please proceed as follows:

(Tube diameter x 2.5 factor) = laid-flat pocket dimension
for example: 2" tube = (6.03 cm x 2.5) = 15.08 cm

The net width is reduced by approx. 18 cm.

Aluminium profile = male + female windseal



Edge reinforcement



Eyelets, 16 mm diameter

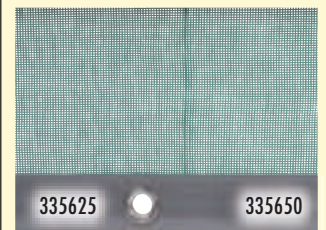

Kador profile

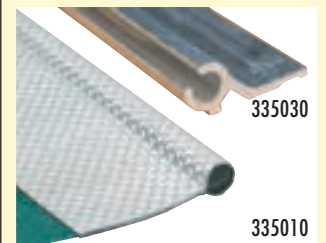

Laid-flat pocket with steel tube and ratchet



Welded-on bottom flap

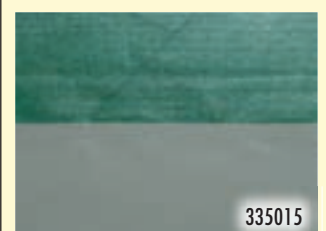

Type	Ref.	Width	Height	
Farmflex 100, Special Mesh	F10/10	up to 10 m	1.00 m	per metre
Farmflex 100, Special Mesh	F10/30	10 to 30 m	1.00 m	per metre
Farmflex 100, Special Mesh	F10/50	30 to 50 m	1.00 m	per metre
Farmflex 100, Special Mesh	F10/100	50 to 100 m	1.00 m	per metre
Farmflex 150, Special Mesh	F15/10	up to 10 m	1.50 m	per metre
Farmflex 150, Special Mesh	F15/30	10 to 30 m	1.50 m	per metre
Farmflex 150, Special Mesh	F15/50	30 to 50 m	1.50 m	per metre
Farmflex 150, Special Mesh	F15/100	50 to 100 m	1.50 m	per metre
Farmflex 200, Special Mesh	F20/10	up to 10 m	2.00 m	per metre
Farmflex 200, Special Mesh	F20/30	10 to 30 m	2.00 m	per metre
Farmflex 200, Special Mesh	F20/50	30 to 50 m	2.00 m	per metre
Farmflex 200, Special Mesh	F20/100	50 to 100 m	2.00 m	per metre
Farmflex 300, Special Mesh	F30/10	up to 10 m	3.00 m	per metre
Farmflex 300, Special Mesh	F30/30	10 to 30 m	3.00 m	per metre
Farmflex 300, Special Mesh	F30/50	30 to 50 m	3.00 m	per metre
Farmflex 300, Special Mesh	F30/100	50 to 100 m	3.00 m	per metre
Farmflex 400, Special Mesh with horizontal welding seam	F40	up to 100 m	3.97 m	per metre
Farmflex 500, Special Mesh with horizontal welding seam	F50	up to 100 m	4.97 m	per metre
Surcharge for high performance mesh				+ 47,5 % + 47,5 %
Bird Net 100 Mesh size 24 x 17 mm	335100		1.00 m	per metre
Bird Net 150 Mesh size 24 x 17 mm	335150		1.50 m	per metre
Bird Net 200 Mesh size 24 x 17 mm	335200		2.00 m	per metre
Bird Net 300 Mesh size 24 x 17 mm	335205		3.00 m	per metre
Surcharge for laid-flat pocket* (Please give dimensions!)	335013			per metre
Surcharge for welding on a kador*	335010			per metre
Surcharge for welded edge reinforcement				
(colour of reinforcing tape: grey)* (50 mm wide)	335011			per metre
Surcharge for welding together (30 mm wide)	335012			per metre
Surcharge for bottom flap, height 50 cm, grey (welded to the netting)	335015			per metre
Surcharge for eyelets every 25 cm* (with edge reinforcement 50 mm wide)	335625			per metre
Surcharge for eyelets every 50 cm* (with edge reinforcement 50 mm wide)	335650			per metre
* For custom-made products, the price for netting up to 10 m is relevant				
Clip-On Aluminium Rail for special mesh and high performance mesh (includes clip-on and clamp bar, length of clip-on 4.0 m)	335009			per metre
Aluminium Kador Profile (Profile length 4.0 m)	335030			per metre
Tensioning Set with Ratchet and Strap 70 cm	335040			
Bungee Cord	335041			
Hook, galvanised, for bungee cord	335042			
Repair Set for Farmflex (1 tin of adhesive, 1m ² mesh)	335900			
Mounting Set (With tension screws, for tensioning the wind protection netting)	335060		1.0 m	
Mounting Set (With tension screws, for tensioning the wind protection netting)	335061		1.5 m	
Mounting Set (With tension screws, for tensioning the wind protection netting)	335062		2.0 m	
Mounting Set (With tension screws, for tensioning the wind protection netting)	335063		3.0 m	

Special Mesh: Standard colour green; special colour at no extra charge: blue, beige, brown (height is 2.00 m only) - grey, black (height is 3.00 m only)
High Performance Mesh: Standard colour green, special colour at no extra charge: grey, black (height is 3.00 m only). **Differing height upon request.**



Tensioning Set with Ratchet

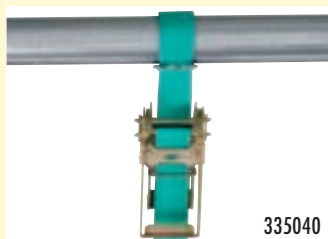

Bungee Cord with Fixing Hook

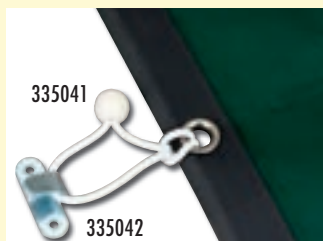

Mounting Set with Tension Screws

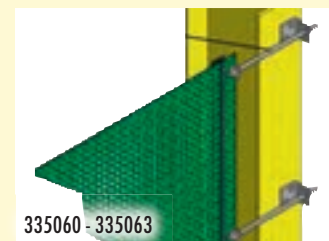



Clip-On Wind & Weather Protection Screens

Wind protection netting easily clips onto existing supports and posts to close every "gap" in the building. Ideal for open-front livestock buildings, machine and storage buildings, and all other buildings where fresh air and light are required, but at the same time draughts, rain and (e.g.) birds are to be kept out. Can be completely removed at any time. Suitable for attaching to steel, wood and concrete. Delivered ready to assemble with sewn-in tensioning straps, ratchets and PVC protective profiles.



Bayscreen – the quick and effective solution to building ventilation



Animal-friendly sheep farming in an open shed with Bayscreen

Technical data for tensioning straps and ratchets

The following tensioning straps are worked into the mesh 50 cm apart. (Hooks for max. post sizes up to 20 mm are suitable)

Mesh dimensions widths	Tensioning straps width/load	Ratchets width/load
3.00 bis 6.10 m	25 mm/1000 kg	25 mm/900 kg
6.10 bis 9.14 m	25 mm/2000 kg	25 mm/2000 kg
9.14 bis 13.70 m	50 mm/3000 kg	50 mm/5000 kg
13.70 bis 18.30 m	50 mm/5000 kg	50 mm/5000 kg

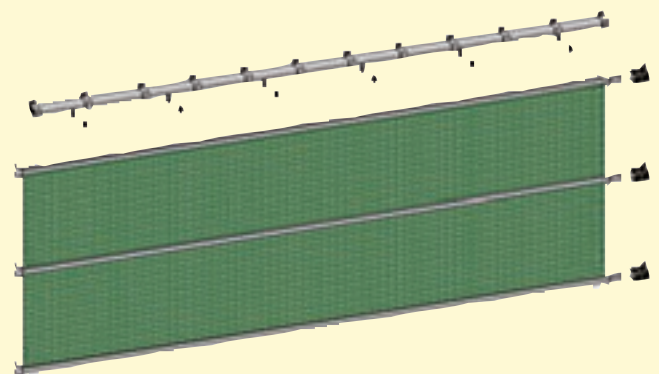

Wind protection Bayscreens combined with a sliding track kit can be used as a light curtain system (recommendation up to 2 m in height). Plastic Roller every 1.0 m (incl. bracket with single roller).

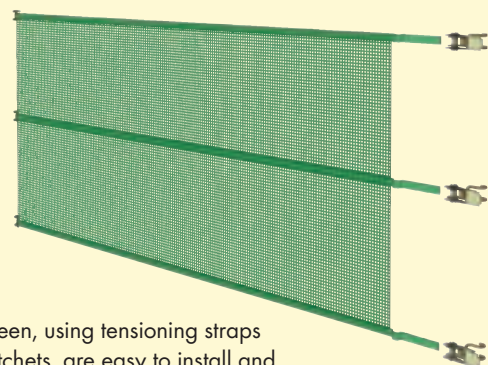

Bayscreen, using tensioning straps and ratchets, are easy to install and remove for access

Type	Ref.	Width	Height	Type	Ref.	Width	Height
Bayscreen 3/1	B3110	3.05 m	1.0 m	Bayscreen 10.7/2	B10720	10.7 m	2.0 m
Bayscreen 3/1.5	B3115	3.05 m	1.5 m	Bayscreen 10.7/3	B10730	10.7 m	3.0 m
Bayscreen 3/2	B3120	3.05 m	2.0 m	Bayscreen 13.7/1	B13710	13.7 m	1.0 m
Bayscreen 3/3	B3130	3.05 m	3.0 m	Bayscreen 13.7/1.5	B13715	13.7 m	1.5 m
Bayscreen 4/1	B4010	4.0 m	1.0 m	Bayscreen 3.7/2	B13720	13.7 m	2.0 m
Bayscreen 4/1.5	B4015	4.0 m	1.5 m	Bayscreen 13.7/3	B13730	13.7 m	3.0 m
Bayscreen 4/2	B4020	4.0 m	2.0 m	Bayscreen 16.8/1	B16810	16.8 m	1.0 m
Bayscreen 4/3	B4030	4.0 m	3.0 m	Bayscreen 16.8/1.5	B16815	16.8 m	1.5 m
Bayscreen 4.6/1	B4610	4.6 m	1.0 m	Bayscreen 16.8/2	B16820	16.8 m	2.0 m
Bayscreen 4.6/1.5	B4615	4.6 m	1.5 m	Bayscreen 16.8/3	B16830	16.8 m	3.0 m
Bayscreen 4.6/2	B4620	4.6 m	2.0 m				
Bayscreen 4.6/3	B4630	4.6 m	3.0 m				
Bayscreen 5/1	B5010	5.0 m	1.0 m	Surcharge for height adjustment			
Bayscreen 5/1.5	B5015	5.0 m	1.5 m	Surcharge for high performance mesh			
Bayscreen 5/2	B5020	5.0 m	2.0 m	Surcharge for solid material			
Bayscreen 5/3	B5030	5.0 m	3.0 m				
Bayscreen 5.5/1	B5510	5.5 m	1.0 m				
Bayscreen 5.5/1.5	B5515	5.5 m	1.5 m	Plastic Edge Protection for metal posts	335059	0.5 m	
Bayscreen 5.5/2	B5520	5.5 m	2.0 m	Sliding Track Kit 4	335070	4.0 m	
Bayscreen 5.5/3	B5530	5.5 m	3.0 m	Sliding Track Kit 5	335071	5.0 m	
Bayscreen 6.1/1	B6110	6.1 m	1.0 m	Sliding Track Kit 6	335072	6.0 m	
Bayscreen 6.1/1.5	B6115	6.1 m	1.5 m	Sliding Track Kit 7	335073	7.0 m	
Bayscreen 6.1/2	B6120	6.1 m	2.0 m	Sliding Track Kit 8	335074	8.0 m	
Bayscreen 6.1/3	B6130	6.1 m	3.0 m	Sliding Track Kit 9	335075	9.0 m	
Bayscreen 7/1	B7010	7.0 m	1.0 m	Sliding Track Kit 10	335076	10.0 m	
Bayscreen 7/1.5	B7015	7.0 m	1.5 m	Sliding Track Kit 11	335077	11.0 m	
Bayscreen 7/2	B7020	7.0 m	2.0 m	Sliding Track Kit 12	335078	12.0 m	
Bayscreen 7/3	B7030	7.0 m	3.0 m	Sliding Track Kit 13	335079	13.0 m	
Bayscreen 7.6/1	B7610	7.6 m	1.0 m	Sliding Track Kit 14	335080	14.0 m	
Bayscreen 7.6/1.5	B7615	7.6 m	1.5 m	Sliding Track Kit 15	335081	15.0 m	
Bayscreen 7.6/2	B7620	7.6 m	2.0 m	Sliding Track Kit 16	335082	16.0 m	
Bayscreen 7.6/3	B7630	7.6 m	3.0 m	Sliding Track Kit 17	335083	17.0 m	
Bayscreen 8/1	B8010	8.0 m	1.0 m	Sliding Track Kit 18	335084	18.0 m	
Bayscreen 8/1.5	B8015	8.0 m	1.5 m	Sliding Track Kit 19	335085	19.0 m	
Bayscreen 8/2	B8020	8.0 m	2.0 m	Sliding Track Kit 20	335086	20.0 m	
Bayscreen 8/3	B8030	8.0 m	3.0 m				
Bayscreen 9.1/1	B9110	9.1 m	1.0 m				
Bayscreen 9.1/1.5	B9115	9.1 m	1.5 m				
Bayscreen 9.1/2	B9120	9.1 m	2.0 m				
Bayscreen 9.1/3	B9130	9.1 m	3.0 m				
Bayscreen 10.7/1	B10710	10.7 m	1.0 m				
Bayscreen 10.7/1.5	B10715	10.7 m	1.5 m				

1. Establishing the dimensions

Dimensions (width/height) of the area to be covered from the left edge of the left post to the right edge of the right post. The length of the mesh in the tensioned state is the length given in the list + 50 mm, tolerance +/- 0.5 %

Bayscreens must always be installed on the outside of a building between supports or posts: e.g., 3 openings 5 m wide should be protected with 3 Bayscreen panels of 5 m each, not one of 15 m (loss of warranty)

2. Fitting adjustment

Width: may be shortened as required, height: no adjustment possible (next possible height +5% surcharge)

3. Colour

Special mesh available in green, blue, beige, grey, brown and black at no extra charge



Plastic edge protection for metal posts (included in delivery) ref. 335059



Quick access to buildings

There are 3 variants of wind protection doors: the Rollerscreen with spring mechanism, the Rapid Rollerdoor and Electric Rollerdoor. All systems allow for simple and rapid sealing of the building openings, while at the same time providing optimum ventilation and weather protection. Ideal for livestock buildings, machine and storage buildings.

Top steel cowl to protect the rolled-up netting (optional)

Heavy-duty, long lasting spring mechanism

Lower fixing J-bracket to secure the bottom steel tubing

Unique locking mechanism for stability in high winds

User-friendly grip with pull cord



Rollerscreen – for quick access above



Type	Ref.	Width	Height	Type	Ref.	Width	Height
Rollerscreen 2.5	RS2521	2.5 m	2.1 m	Top Steel Cowling 2.5	335090	2.5 m	
Rollerscreen 2.5/3	RS2531	2.5 m	3.1 m	Top Steel Cowling 3.0	335091	3.0 m	
Rollerscreen 2.5/4	RS2541	2.5 m	4.1 m	Top Steel Cowling 3.5	335092	3.5 m	
Rollerscreen 3/2	RS3021	3.0 m	2.1 m	Top Steel Cowling 4.0	335093	4.0 m	
Rollerscreen 3/3	RS3031	3.0 m	3.1 m	Top Steel Cowling 4.5	335094	4.5 m	
Rollerscreen 3/4	RS3041	3.0 m	4.1 m	Top Steel Cowling 5.0	335095	5.0 m	
Rollerscreen 3.5/2	RS3521	3.5 m	2.1 m	Top Steel Cowling 5.5	335096	5.5 m	
Rollerscreen 3.5/3	RS3531	3.5 m	3.1 m	Top Steel Cowling 6.0	335097	6.0 m	
Rollerscreen 3.5/4	RS3541	3.5 m	4.1 m				
Rollerscreen 4/2	RS4021	4.0 m	2.1 m	Bottom Flap with Kador Cord	505040	per m	14 cm
Rollerscreen 4/3	RS4031	4.0 m	3.1 m	Bottom Flap with Kador Cord	505041	per m	34 cm
Rollerscreen 4/4	RS4041	4.0 m	4.1 m	Bottom Flap with Kador Cord	505042	per m	51 cm
Rollerscreen 4.5/2	RS4521	4.5 m	2.1 m				
Rollerscreen 4.5/3	RS4531	4.5 m	3.1 m	J-Bracket Set, additional (content: 2 pcs)	335050		
Rollerscreen 4.5/4	RS4541	4.5 m	4.1 m				
Rollerscreen 5/2	RS5021	5.0 m	2.1 m	Surcharge for high performance mesh			
Rollerscreen 5/3	RS5031	5.0 m	3.1 m				
Rollerscreen 5/4	RS5041	5.0 m	4.1 m	Surcharge for solid material			
Rollerscreen 5.5/2	RS5521	5.5 m	2.1 m				
Rollerscreen 5.5/3	RS5531	5.5 m	3.1 m				
Rollerscreen 5.5/4	RS5541	5.5 m	4.1 m				
Rollerscreen 6/2	RS6021	6.0 m	2.1 m				
Rollerscreen 6/3	RS6031	6.0 m	3.1 m				
Rollerscreen 6/4	RS6041	6.0 m	4.1 m				

1. Steel tubing

All Rollerscreens are delivered with 100 mm diameter tube.

2. Establishing the dimensions

The width and height of the ordered Rollerscreens dictate the actual width of the mesh. The tubes are 100 mm longer than the mesh width (50 mm on each side).

On Rollerscreens the spring mechanism is always on the left. Clearance height reduces by 100 mm.

3. Fitting adjustment

Rollerscreen: minimum width 2.35 m

The height can be varied by the positioning of the tube (superfluous net remains wrapped on the tube).

4. Bottom flap

Bottom flaps in heights of 14 cm, 34 cm and 51 cm can be supplied

5. Locking mechanism

All Rollerscreens are equipped with a locking mechanism which prevents an unintentional spring-back.

Safety information: the rewind spring is extremely strong. Please check when operating the Rollerscreens that there is nobody in the area of the lower tube. If the rewind spring needs to be replaced, ensure that the spring retention screw is screwed in before removing the old spring.

6. Colour

Special mesh available in green, blue, beige, grey, brown and black at no extra charge

The mesh width can be cut to size on site, for height adjustment any remainder can remain wound onto the upper tube.



Optimum access to buildings

Rapid Rollerdoors are of the same construction as Electric Rollerdoors. Rapid Rollerdoors can be operated with little effort using a chain drive. By including the optional side guide rails, the door is additionally sealed and can still be opened easily even in light wind conditions. The door is sealed at the bottom with a bottom flap, compensating for any ground unevenness.

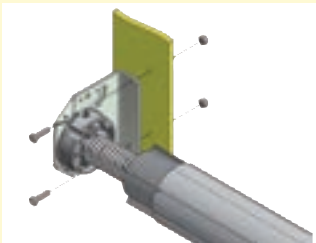

Sturdy spring for power-assisted door opening and for more safety

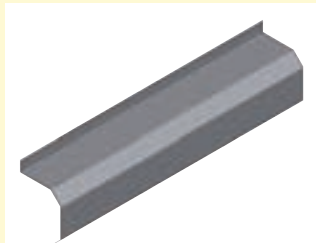

Top steel cowling to protect the rolled-up netting (optional)



Robust, rigid steel tube of 100 mm diameter for long life

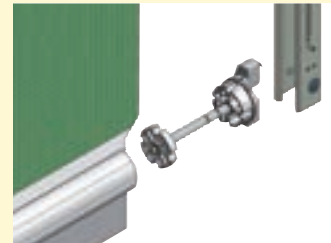

Long-lasting nylon wind lockers and rugged U-profile rail ensure high stability



Semi-automatic locking catch for storm protection

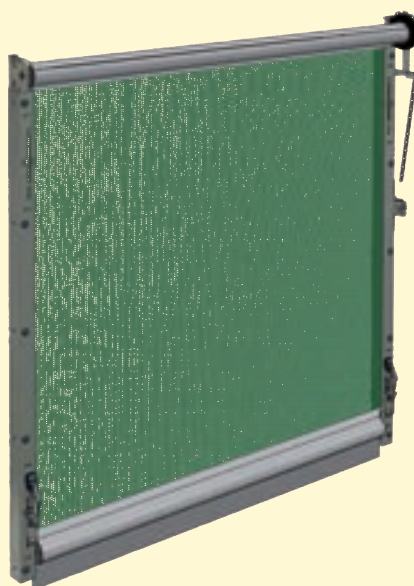

Rapid Rollerdoor with side guide rails



The fast, sturdy and easy-to-operate chain drive - 2 s/m

Type	Ref.	Width	Height
Rapid Rollerdoor with guide rails 2.5/3	RR2531FS	2.5 m	3.1 m
Rapid Rollerdoor with guide rails 2.5/4	RR2541FS	2.5 m	4.1 m
Rapid Rollerdoor with guide rails 2.5/5	RR2551FS	2.5 m	5.1 m
Rapid Rollerdoor with guide rails 3/3	RR3031FS	3.0 m	3.1 m
Rapid Rollerdoor with guide rails 3/4	RR3041FS	3.0 m	4.1 m
Rapid Rollerdoor with guide rails 3/5	RR3051FS	3.0 m	5.1 m
Rapid Rollerdoor with guide rails 3.5/3	RR3531FS	3.5 m	3.1 m
Rapid Rollerdoor with guide rails 3.5/4	RR3541FS	3.5 m	4.1 m
Rapid Rollerdoor with guide rails 3.5/5	RR3551FS	3.5 m	5.1 m
Rapid Rollerdoor with guide rails 4/3	RR4031FS	4.0 m	3.1 m
Rapid Rollerdoor with guide rails 4/4	RR4041FS	4.0 m	4.1 m
Rapid Rollerdoor with guide rails 4/5	RR4051FS	4.0 m	5.1 m
Rapid Rollerdoor with guide rails 4.5/3	RR4531FS	4.5 m	3.1 m
Rapid Rollerdoor with guide rails 4.5/4	RR4541FS	4.5 m	4.1 m
Rapid Rollerdoor with guide rails 4.5/5	RR4551FS	4.5 m	5.1 m
Rapid Rollerdoor with guide rails 5/3	RR5031FS	5.0 m	3.1 m
Rapid Rollerdoor with guide rails 5/4	RR5041FS	5.0 m	4.1 m
Rapid Rollerdoor with guide rails 5/5	RR5051FS	5.0 m	5.1 m
Rapid Rollerdoor with guide rails 5.5/3	RR5531FS	5.5 m	3.1 m
Rapid Rollerdoor with guide rails 5.5/4	RR5541FS	5.5 m	4.1 m
Rapid Rollerdoor with guide rails 6/3	RR6031FS	6.0 m	3.1 m
Rapid Rollerdoor with guide rails 6/4	RR6041FS	6.0 m	4.1 m
Now with guide rails			
Top Steel Cowling 2.5	335090	2.5 m	
Top Steel Cowling 3.0	335091	3.0 m	
Top Steel Cowling 3.5	335092	3.5 m	
Top Steel Cowling 4.0	335093	4.0 m	
Top Steel Cowling 4.5	335094	4.5 m	
Top Steel Cowling 5.0	335095	5.0 m	
Top Steel Cowling 5.5	335096	5.5 m	
Top Steel Cowling 6.0	335097	6.0 m	
Surcharge for high performance mesh			
Surcharge for solid material			
Surcharge for bottom flap with kador cord	505036	per m	34 cm
Surcharge for bottom flap with kador cord	505037	per m	51 cm

1. Steel tubing

All Rapid Rollerdoors and Electric Rollerdoors are delivered with 100 mm diameter tube

2. Establishing the dimensions

The width and height of the ordered Rapid Rollerdoor dictate the actual dimensions of the mesh. The tubes are approximately 100 mm longer than the rollerdoor width (50 mm on each side). The maximum mounting width measures the nominal width -3 cm (e.g. RR2531FS = max. Mounting width 2.47 m). On Rapid Rollerdoors the drive can be mounted on the right or the left. Please specify desired drive side when ordering. Clearance height reduces by 100 mm.

3. Fitting adjustment

Minimum width 2.40 m. The height can be varied by the positioning of the tube (superfluous net remains wrapped on the tube).

4. Bottom flap

Rapid Rollerdoors are delivered with a bottom flap of 14 cm as standard. Bottom flaps of 34 cm and 51 cm can be supplied at a surcharge.

5. Guide rails

All Rollerdoors can be equipped with side guide rails. This ensures a tight closure of the door at the sides and allows the user to operate the door even at high wind speeds.

6. Colour

Special mesh available in green, blue, beige, grey, brown and black at no extra charge



The rollerdoor width has to be cut to size on site, for height adjustment any remainder can remain wound onto the upper tube.



Optimum access to buildings

Electric Rollerdoors are driven by a motor integrated in the upper tubing and controlled through a switch. By adding side guide rails, the door has an additional tight closure and can be opened even at light wind conditions. The door is sealed at the bottom with a bottom flap, compensating for any ground unevenness.

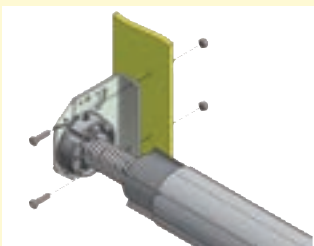

Sturdy spring for power-assisted door opening and for more safety

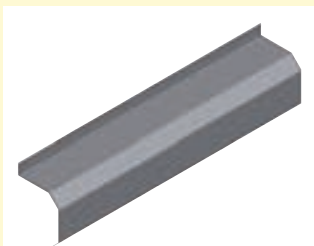

Top steel cowling to protect the rolled-up netting (optional)



Robust, rigid steel tube of 100 mm diameter for long life

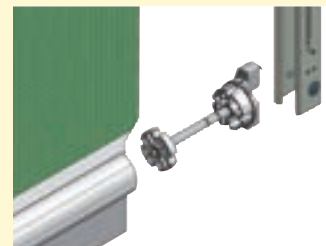

Long-lasting nylon wind lockers and rugged U-profile rail ensure high stability



Semi-automatic locking catch for storm protection

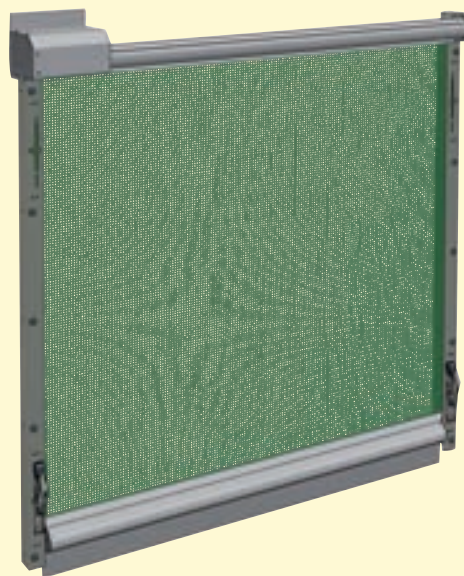

Electric Rollerdoors with side guide rails

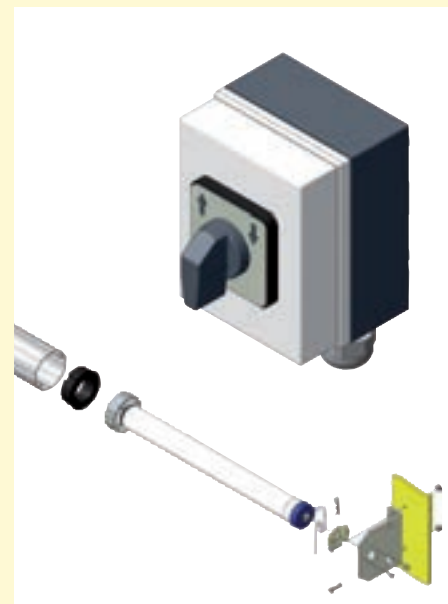

Electric drive with 230 V tubular motor and rotary switch in latched position - 16 s/m

Type	Ref.	Width	Height
Electric Rollerdoor with guide rails 2.5/3	RDE2531FS	2.5 m	3.1 m
Electric Rollerdoor with guide rails 2.5/4	RDE2541FS	2.5 m	4.1 m
Electric Rollerdoor with guide rails 2.5/5	RDE2551FS	2.5 m	5.1 m
Electric Rollerdoor with guide rails 3/3	RDE3031FS	3.0 m	3.1 m
Electric Rollerdoor with guide rails 3/4	RDE3041FS	3.0 m	4.1 m
Electric Rollerdoor with guide rails 3/5	RDE3051FS	3.0 m	5.1 m
Electric Rollerdoor with guide rails 3.5/3	RDE3531FS	3.5 m	3.1 m
Electric Rollerdoor with guide rails 3.5/4	RDE3541FS	3.5 m	4.1 m
Electric Rollerdoor with guide rails 3.5/5	RDE3551FS	3.5 m	5.1 m
Electric Rollerdoor with guide rails 4/3	RDE4031FS	4.0 m	3.1 m
Electric Rollerdoor with guide rails 4/4	RDE4041FS	4.0 m	4.1 m
Electric Rollerdoor with guide rails 4/5	RDE4051FS	4.0 m	5.1 m
Electric Rollerdoor with guide rails 4.5/3	RDE4531FS	4.5 m	3.1 m
Electric Rollerdoor with guide rails 4.5/4	RDE4541FS	4.5 m	4.1 m
Electric Rollerdoor with guide rails 4.5/5	RDE4551FS	4.5 m	5.1 m
Electric Rollerdoor with guide rails 5/3	RDE5031FS	5.0 m	3.1 m
Electric Rollerdoor with guide rails 5/4	RDE5041FS	5.0 m	4.1 m
Electric Rollerdoor with guide rails 5/5	RDE5051FS	5.0 m	5.1 m
Electric Rollerdoor with guide rails 5.5/3	RDE5531FS	5.5 m	3.1 m
Electric Rollerdoor with guide rails 5.5/4	RDE5541FS	5.5 m	4.1 m
Electric Rollerdoor with guide rails 6/3	RDE6031FS	6.0 m	3.1 m
Electric Rollerdoor with guide rails 6/4	RDE6041FS	6.0 m	4.1 m
Now with guide rails			
Top Steel Cowling 2.5	335090	2.5 m	
Top Steel Cowling 3.0	335091	3.0 m	
Top Steel Cowling 3.5	335092	3.5 m	
Top Steel Cowling 4.0	335093	4.0 m	
Top Steel Cowling 4.5	335094	4.5 m	
Top Steel Cowling 5.0	335095	5.0 m	
Top Steel Cowling 5.5	335096	5.5 m	
Top Steel Cowling 6.0	335097	6.0 m	
Surcharge for high performance mesh			
Surcharge for solid material			
Surcharge for bottom flap with kador cord			
	505036	per m	34 cm
Surcharge for bottom flap with kador cord			
	505037	per m	51 cm

1. Steel tubing

All Electric Rollerdoors are delivered with 100 mm diameter tube

2. Establishing the dimensions

The width and height of the ordered Electric Rollerdoor dictate the clear opening dimensions of the door. The effective width is approx. 80 mm wider than the clear opening width. With electric roller doors, the drive is mounted on the right side. The clearance height reduces by 100 mm.

3. Fitting adjustment

Minimum width 2.40 m. The height can be varied by the positioning of the tube (superfluous net remains wrapped on the tube).

4. Bottom flap

Electric Rollerdoors are delivered with a bottom flap of 14 cm as standard. Bottom flaps of 34 cm and 51 cm can be supplied at a surcharge.

5. Guide rails

All Rollerdoors can be equipped with side guide rails. This ensures a tight closure of the door at the sides and allows the user to operate the door even at high wind speeds.

6. Colour

Special mesh available in green, blue, beige, grey, brown and black at no extra charge

The rollerdoor width has to be cut to size on site, for height adjustment any remainder can remain wound onto the upper tube.

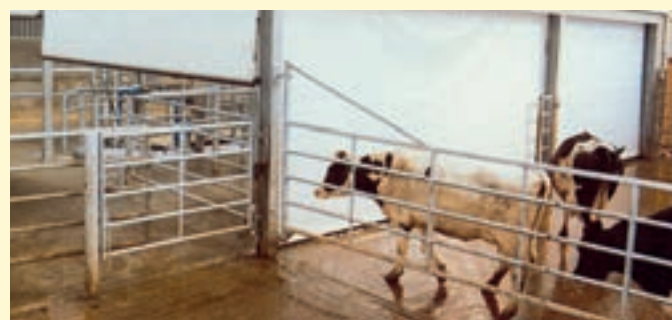

Interior Electric Rollerdoor as parlour door



Optimum access to buildings

Agridoors have side guide rails, and offer protection, ventilation and access to farm buildings. The horizontal tubes offer stabilisation and strengthening of the netting. The door is operated easily and quickly by means of a chain drive.

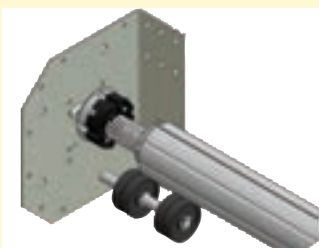

Sturdy spring for power-assisted door opening and for more safety

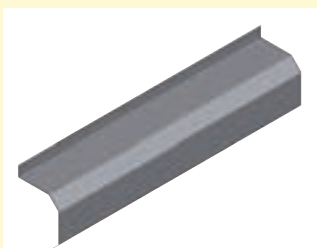

Full cowling to protect the rolled-up netting (optional)



Robust, rigid steel tube of 100 mm diameter for long life

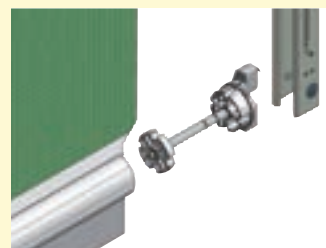

Long-lasting nylon wind lockers and rugged U-profile rail ensure high stability

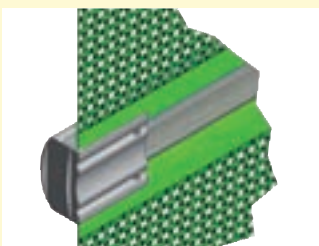

Formed steel tubing for highest stability, equipped with nylon end caps for reduced noise

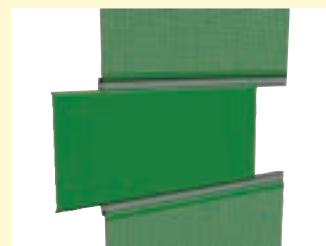

Selection of various materials/colours



Semi-automatic locking catch for storm protection

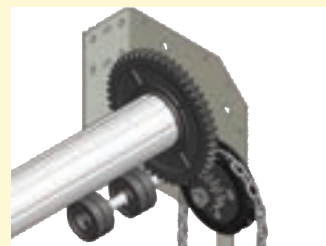

The quick, robust and easy-to-operate chain drive - 5 s/m

Type	Ref.	Width	Height	Type	Ref.	Width	Height
Agridoor 2.5/3	AG2531	2.5 m	3.1 m	Top Steel Cowling for Agridoor 2.5	335540	2.5 m	
Agridoor 2.5/4	AG2541	2.5 m	4.1 m	Top Steel Cowling for Agridoor 3	335541	3.0 m	
Agridoor 2.5/5	AG2551	2.5 m	5.1 m	Top Steel Cowling for Agridoor 3.5	335542	3.5 m	
Agridoor 2.5/6	AG2561	2.5 m	6.1 m	Top Steel Cowling for Agridoor 4	335543	4.0 m	
Agridoor 3/3	AG3031	3.0 m	3.1 m	Top Steel Cowling for Agridoor 4.5	335544	4.5 m	
Agridoor 3/4	AG3041	3.0 m	4.1 m	Top Steel Cowling for Agridoor 5	335545	5.0 m	
Agridoor 3/5	AG3051	3.0 m	5.1 m	Top Steel Cowling for Agridoor 5.5	335546	5.5 m	
Agridoor 3/6	AG3061	3.0 m	6.1 m	Top Steel Cowling for Agridoor 6.0	335547	6.0 m	
Agridoor 3.5/3	AG3531	3.5 m	3.1 m	Surcharge for high performance mesh			
Agridoor 3.5/4	AG3541	3.5 m	4.1 m	Surcharge for solid material			
Agridoor 3.5/5	AG3551	3.5 m	5.1 m	Surcharge for bottom flap with kador cord			505036 per m 34 cm
Agridoor 3.5/6	AG3561	3.5 m	6.1 m	Surcharge for bottom flap with kador cord			505037 per m 51 cm
Agridoor 4/3	AG4031	4.0 m	3.1 m				
Agridoor 4/4	AG4041	4.0 m	4.1 m				
Agridoor 4/5	AG4051	4.0 m	5.1 m				
Agridoor 4/6	AG4061	4.0 m	6.1 m				
Agridoor 4.5/3	AG4531	4.5 m	3.1 m				
Agridoor 4.5/4	AG4541	4.5 m	4.1 m				
Agridoor 4.5/5	AG4551	4.5 m	5.1 m				
Agridoor 4.5/6	AG4561	4.5 m	6.1 m				
Agridoor 5/3	AG5031	5.0 m	3.1 m				
Agridoor 5/4	AG5041	5.0 m	4.1 m				
Agridoor 5/5	AG5051	5.0 m	5.1 m				
Agridoor 5/6	AG5061	5.0 m	6.1 m				
Agridoor 5.5/3	AG5531	5.5 m	3.1 m				
Agridoor 5.5/4	AG5541	5.5 m	4.1 m				
Agridoor 5.5/5	AG5551	5.5 m	5.1 m				
Agridoor 5.5/6	AG5561	5.5 m	6.1 m				
Agridoor 6/3	AG6031	6.0 m	3.1 m				
Agridoor 6/4	AG6041	6.0 m	4.1 m				
Agridoor 6/5	AG6051	6.0 m	5.1 m				
Agridoor 6/6	AG6061	6.0 m	6.1 m				

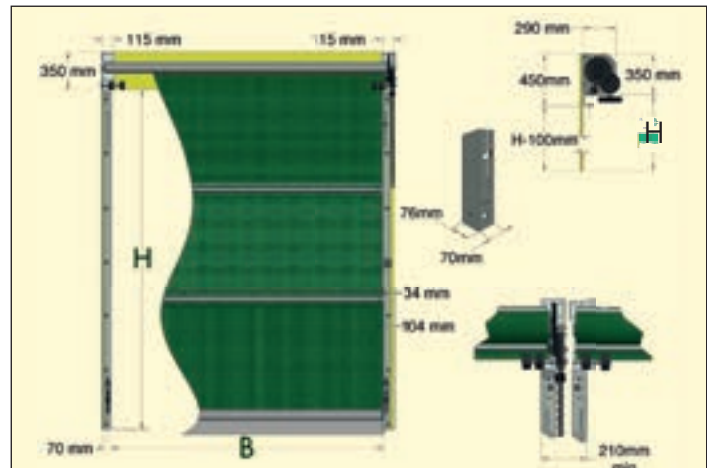

1. Establishing the dimensions

Establish the clear width 'B' of the opening and the planned height 'H' to the bottom edge of the installation angle. If the established dimensions fall between 2 sizes in the price list, order the door with the next largest dimensions. When ordering indicate operating side: 'Option R' (right) or 'Option L' (left). The height of the Agridoor can be reduced in that some material can be left rolled on the uppermost tube. In the open condition Agridoors lose 100 mm in height from bottom edge of the installation angle. E.g., an Agridoor with the ordered height of 4.1 m (Hmax = 4.1 m) allows clear access of 4.00 m when rolled up

2. Checking the installation site

Check that there are no obstructions (e.g. gutters, drain pipes, door fittings, etc.) which might interfere with the installation of the top angle or side guide rails

3. Bottom flap

Agridoors are delivered with a grey bottom flap of 14 cm as standard. Bottom flaps with a height of 34 cm and 51 cm are available at an additional price.

4. Type of drive

Chain drive - 5 s/m

5. Colour

Special mesh available in green, blue, beige, grey, brown and black at no extra charge

When ordering please request drive right or left (for chain drive only)



The mesh width can be cut to size on site, for height adjustment any remainder can remain wound onto the upper tube.

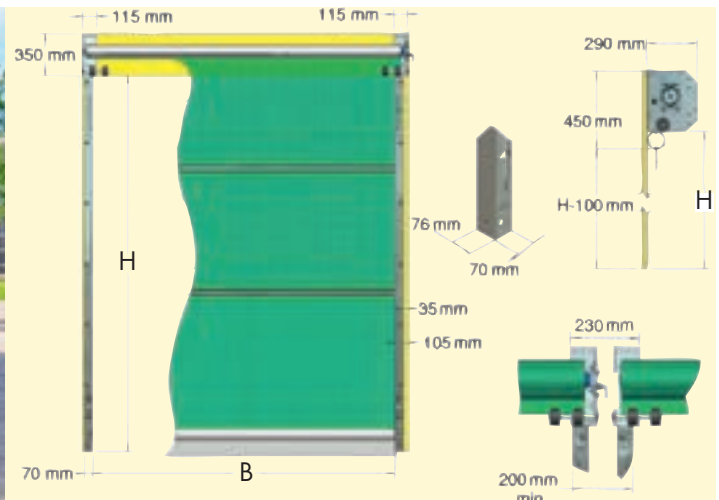

Optimum access to buildings

Agridoors have side guide rails, and offer protection, ventilation and access to farm buildings. The horizontal tubes offer stabilisation and strengthening of the netting. The door is operated easily and quickly by means of an electric motor (230 V - 9 s/m) with different control options (rotary switch, control box with 2 switches, remote control).

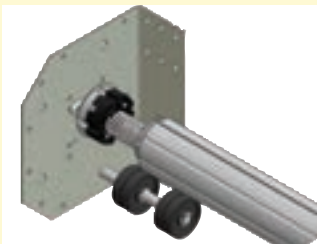

Sturdy spring for power-assisted door opening and for more safety

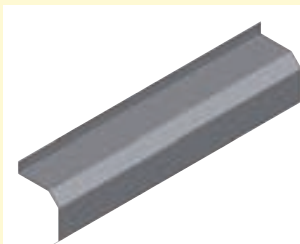

Full cowling to protect the rolled-up netting (optional)



Robust, rigid steel tube of 100 mm diameter for long life

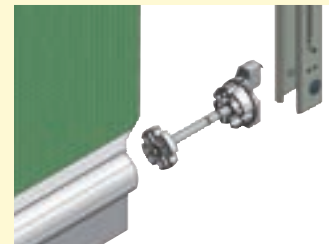

Long-lasting nylon wind lockers and rugged U-profile rail ensure high stability

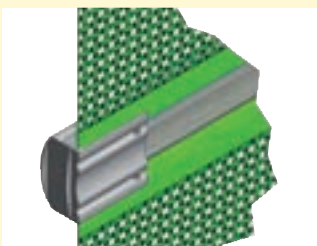

Formed steel tubing for highest stability, equipped with nylon end caps for reduced noise

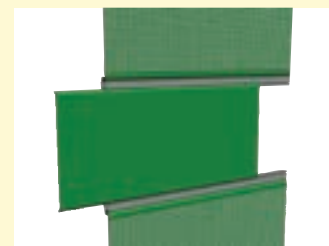

Selection of various materials/ colours



Patented fully automatic locking catches combined with electrical drive Ref. 335562/335563

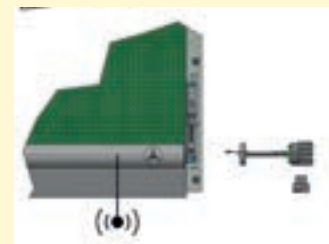

Safety edge for remote controlled systems as standard

Type	Ref.	Width	Height	Type	Ref.	Width	Height	
Agridoor 2.5/3	AGET2531	2.5 m	3.1 m	Top Steel Cowling for Agridoor 4	335543	4.0 m		
Agridoor 2.5/4	AGET2541	2.5 m	4.1 m	Top Steel Cowling for Agridoor 4.5	335544	4.5 m		
Agridoor 2.5/5	AGET2551	2.5 m	5.1 m	Top Steel Cowling for Agridoor 5	335545	5.0 m		
Agridoor 2.5/6	AGET2561	2.5 m	6.1 m	Top Steel Cowling for Agridoor 5.5	335546	5.5 m		
Agridoor 3/3	AGET3031	3.0 m	3.1 m	Top Steel Cowling for Agridoor 6.0	335547	6.0 m		
Agridoor 3/4	AGET3041	3.0 m	4.1 m	Top Steel Cowling for Agridoor 2.5	335540	2.5 m		
Agridoor 3/5	AGET3051	3.0 m	5.1 m	Top Steel Cowling for Agridoor 3	335541	3.0 m		
Agridoor 3/6	AGET3061	3.0 m	6.1 m	Top Steel Cowling for Agridoor 3.5	335542	3.5 m		
Agridoor 3.5/3	AGET3531	3.5 m	3.1 m					
Agridoor 3.5/4	AGET3541	3.5 m	4.1 m	Electrical Drive 1 switch	335560			
Agridoor 3.5/5	AGET3551	3.5 m	5.1 m					
Agridoor 3.5/6	AGET3561	3.5 m	6.1 m	Electrical Drive with	335562			
Agridoor 4/3	AGET4031	4.0 m	3.1 m	Control Box, 2. Switch and emergency operation				
Agridoor 4/4	AGET4041	4.0 m	4.1 m	Electrical Drive with	335563			
Agridoor 4/5	AGET4051	4.0 m	5.1 m	Control Box, 2 Switch, Remote Control and emergency operation				
Agridoor 4/6	AGET4061	4.0 m	6.1 m	Radio Transmitter, extra	335564			
Agridoor 4.5/3	AGET4531	4.5 m	3.1 m	Safety Edge Kit 2.5	335570	2.5 m		
Agridoor 4.5/4	AGET4541	4.5 m	4.1 m	Safety Edge Kit 3.0	335571	3.0 m		
Agridoor 4.5/5	AGET4551	4.5 m	5.1 m	Safety Edge Kit 3.5	335572	3.5 m		
Agridoor 4.5/6	AGET4561	4.5 m	6.1 m	Safety Edge Kit 4.0	335573	4.0 m		
Agridoor 5/3	AGET5031	5.0 m	3.1 m	Safety Edge Kit 4.5	335574	4.5 m		
Agridoor 5/4	AGET5041	5.0 m	4.1 m	Safety Edge Kit 5.0	335575	5.0 m		
Agridoor 5/5	AGET5051	5.0 m	5.1 m	Safety Edge Kit 5.5	335576	5.5 m		
Agridoor 5/6	AGET5061	5.0 m	6.1 m	Safety Edge Kit 6.0	335577	6.0 m		
Agridoor 5.5/3	AGET5531	5.5 m	3.1 m					
Agridoor 5.5/4	AGET5541	5.5 m	4.1 m					
Agridoor 5.5/5	AGET5551	5.5 m	5.1 m					
Agridoor 5.5/6	AGET5561	5.5 m	6.1 m					
Agridoor 6/3	AGET6031	6.0 m	3.1 m					
Agridoor 6/4	AGET6041	6.0 m	4.1 m					
Agridoor 6/5	AGET6051	6.0 m	5.1 m					
Agridoor 6/6	AGET6061	6.0 m	6.1 m					
Surcharge for high performance mesh								
Surcharge for solid material								

! When operated with a remote control the safety edge kit is essential

1. Establishing the dimensions

Establish the clear width 'B' of the opening and the planned height 'H' to the bottom edge of the installation angle. If the established dimensions fall between 2 sizes in the price list, order the door with the next largest dimensions. When ordering indicate operating side: 'Option R' (right) or 'Option L' (left). The height of the Agridoor can be reduced in that some material can be left rolled on the uppermost tube. In the open condition Agridoors lose 100 mm in height from bottom edge of the installation angle. E.g., an Agridoor with the ordered height of 4.1 m (Hmax = 4.1 m) allows clear access of 4.00 m when rolled up

2. Checking the installation site

Check that there are no obstructions (e.g. gutters, drain pipes, door fittings, etc.) which might interfere with the installation of the top angle or side guide rails

3. Bottom flap

Agridoors are delivered with a reinforced black bottom flap of 20 cm as standard

4. Type of drive

- 230 V / 435 W tube motor (9 s/m), friction clutch, control option: rotary drive switch, control box and wireless remote control (shockproof and waterproof)
- When operated with an electrical drive and a remote control the safety edge kit is essential

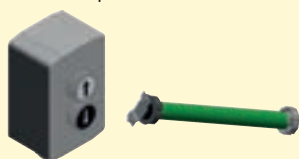

Electric Drive 230 V (9 sec/m) with Rotary Switch (ref. 335560) and semi-automatic locking

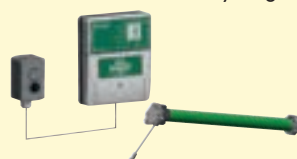

Electric Drive 230 V (9 sec/m) with Control Box, 2. Switch and Emergency Operation (ref. 335562) and automatic locking system

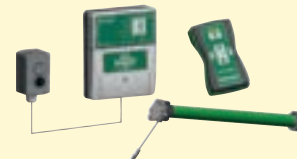

Electric Drive 230 V (9 sec/m) with Control Box, 2. Switch, Remote Control and Emergency Operation (ref. 335563) and automatic locking system. In addition, order Safety Edge Kit

5. Colour

Special mesh available in green, blue, beige, grey, brown and black at no extra charge

The mesh width can be cut to size on site, for height adjustment any remainder can remain wound onto the upper tube.

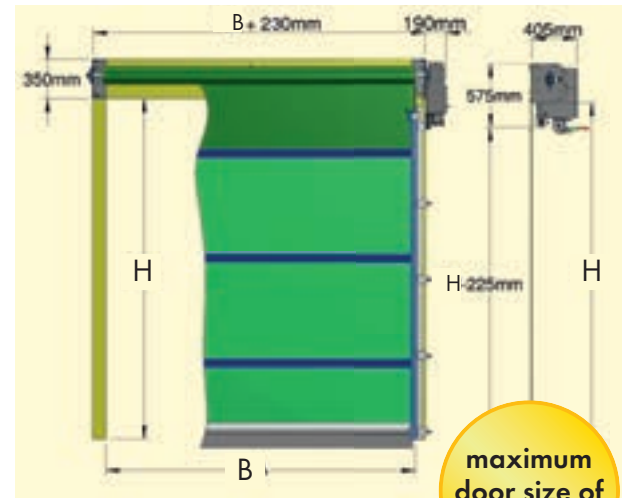

maximum door size of 55 m²

Agridoor PLUS: Professional solutions for wide openings

The PATURA Agridoor PLUS is particularly well suitable for large openings up to 55 m² surface. The winding shaft is a robust, rigid octagonal aluminum tube (d = 157 mm). The horizontal tubes offer stabilisation and strengthening of the netting. The door is operated by means of an electric motor (230 V or 400 V - 9 s/m) with different control options. Optionally we offer a remote control and a safety edge kit. The Motor is flanch-mounted at the side of the winding shaft.

<p>Robust, rigid octagonal aluminum tube of 157 mm diameter for long life</p>	<p>Full cowling to protect the rolledup netting (optional)</p>	<p>Emergency operation through chain drive possible</p>	<p>Profiled wind bar for equal balance of wind load - ball bearing mounted rollers for a high durability</p>
<p>Strong guide rails guarantee high stability with long life</p>			<p>Selection of various materials/colours</p>
			<p>Safety edge for remote controlled systems as standard</p>

Type	Ref.	Width	Height	Type	Ref.	Width	Height
Agridoor PLUS 5/7	AGPE5070	5.0 m	7.0 m	Surcharge for high performance mesh			
Agridoor PLUS 5/8	AGPE5080	5.0 m	8.0 m	Surcharge for solid material			
Agridoor PLUS 5/9	AGPE5090	5.0 m	9.0 m				
Agridoor PLUS 5/10	AGPE50100	5.0 m	10.0 m	Electrical Drive 230 V	335550		
Agridoor PLUS 6/5	AGPE6050	6.0 m	5.0 m	with Control Box and 2 Switches			
Agridoor PLUS 6/6	AGPE6060	6.0 m	6.0 m	Electrical Drive 400 V	335551		
Agridoor PLUS 6/7	AGPE6070	6.0 m	7.0 m	with Control Box and 2 Switches			
Agridoor PLUS 6/8	AGPE6080	6.0 m	8.0 m				
Agridoor PLUS 6/9	AGPE6090	6.0 m	9.0 m				
Agridoor PLUS 7/5	AGPE7050	7.0 m	5.0 m				
Agridoor PLUS 7/6	AGPE7060	7.0 m	6.0 m				
Agridoor PLUS 7/7	AGPE7070	7.0 m	7.0 m				
Agridoor PLUS 7/8	AGPE7080	7.0 m	8.0 m				
Agridoor PLUS 8/5	AGPE8050	8.0 m	5.0 m				
Agridoor PLUS 8/6	AGPE8060	8.0 m	6.0 m				
Agridoor PLUS 8/7	AGPE8070	8.0 m	7.0 m				
Agridoor PLUS 9/5	AGPE9050	9.0 m	5.0 m				
Agridoor PLUS 9/6	AGPE9060	9.0 m	6.0 m				
Agridoor PLUS 10/5	AGPE10050	10.0 m	5.0 m				

Electric Drive with Switch Control

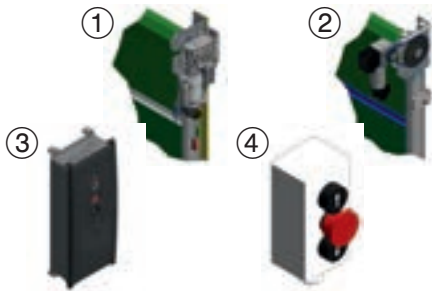

- ① Direct Drive 230 V or 400 V motor
- ② Indirect Drive 230 V or 400 V motor (optional)
- ③ Control Box with direction control
- ④ 2. Switch with direction control

Please order electric motor SEPARATELY

Electric Drive with Remote Control

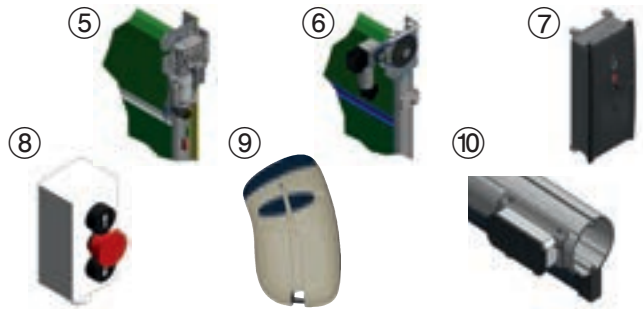

- ⑤ Direct Drive with 230 V or 400 V motor
- ⑥ Indirect Drive with 230 V or 400 V motor (optional)
- ⑦ Control Box with direction control and remote control
- ⑧ 2. Switch with direction control
- ⑨ Remote Control
- ⑩ Safety Edge Kit

1. Establishing the dimensions

Establish the clear width 'B' of the opening and the planned height 'H' to the bottom edge of the installation angle. If the established dimensions fall between 2 sizes in the price list, order the door with the next largest dimensions. The door is made to the specified size. When ordering indicate operating side: 'Option R' (right) or 'Option L' (left). When the door is open, the clear passage height is reduced by 22.5 cm.

2. Checking the installation site

Check that there are no obstructions (e.g. gutters, drain pipes, door fittings, etc.) which might interfere with the installation of the top angle or side guide rails

3. Bottom flap

Agridoors PLUS are delivered with a grey bottom flap of 20 cm as standard

4. Type of drive

- 1. Direct Drive 230 V / 750 W Motor (7 s/m), Control Box and 2.Switch (Ref. 335550)
 - 2. Direct Drive 400 V / 400 W Motor (7 s/m), Control Box and 2.Switch (Ref. 335551)
- If there isn't enough space for a motor, we can offer an indirect drive for additional charge. Price upon request.

5. Colour

Special mesh available in green, blue, beige, grey, brown and black at no extra charge

This is a customised system - local adjustments aren't possible. Please make sure to get exact dimensions of the clear opening and the correct side for motor installation.



Ideal for large openings and doors

For doors with an opening of more than 6 m, Rollerdoors are not sufficiently wind-safe. For this area of operation the Trackscreen curtain was developed. The entire curtain slides on massive rollers in a track, while being additional stabilised with built-in tensioning straps. Recommended for wind speeds up to 88 km/h.



When opened, a Trackscreen requires only a small amount of space



Ratchets ensure firm tensioning even in high winds



Trackscreen curtains for optimal light and climate conditions, the complete front of the indoor riding ring can be opened by sliding the curtain to one side

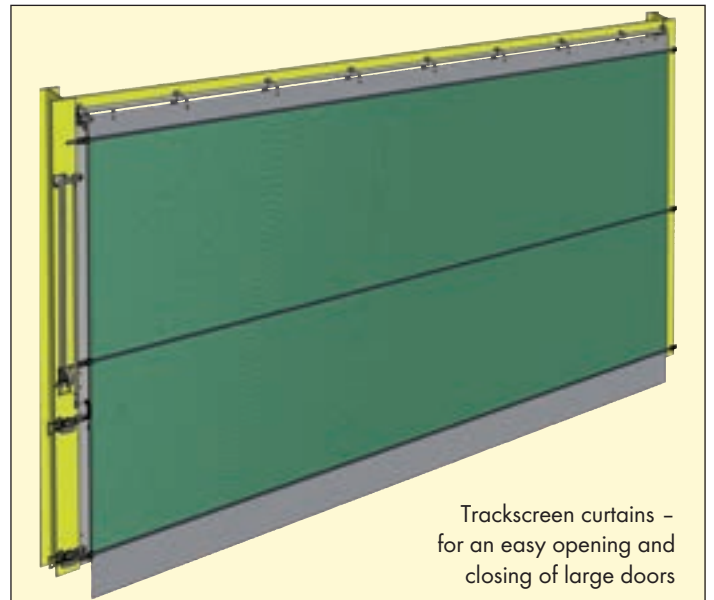

Trackscreen curtains - for an easy opening and closing of large doors

Type	Ref.	Width	Height	Type	Ref.	Width	Height
Trackscreen 7/3	TS7030	7 m	to 3 m	Trackscreen 17/5	TS17050	17 m	to 5 m
Trackscreen 7/4	TS7040	7 m	to 4 m	Trackscreen 18/3	TS18030	18 m	to 3 m
Trackscreen 7/5	TS7050	7 m	to 5 m	Trackscreen 18/4	TS18040	18 m	to 4 m
Trackscreen 8/3	TS8030	8 m	to 3 m	Trackscreen 18/5	TS18050	18 m	to 5 m
Trackscreen 8/4	TS8040	8 m	to 4 m	Trackscreen 19/3	TS19030	19 m	to 3 m
Trackscreen 8/5	TS8050	8 m	to 5 m	Trackscreen 19/4	TS19040	19 m	to 4 m
Trackscreen 9/3	TS9030	9 m	to 3 m	Trackscreen 19/5	TS19050	19 m	to 5 m
Trackscreen 9/4	TS9040	9 m	to 4 m	Trackscreen 20/3	TS20030	20 m	to 3 m
Trackscreen 9/5	TS9050	9 m	to 5 m	Trackscreen 20/4	TS20040	20 m	to 4 m
Trackscreen 10/3	TS10030	10 m	to 3 m	Trackscreen 20/5	TS20050	20 m	to 5 m
Trackscreen 10/4	TS10040	10 m	to 4 m				
Trackscreen 10/5	TS10050	10 m	to 5 m	Surcharge for high performance mesh		+ 15 %	+ 15 %
Trackscreen 11/3	TS11030	11 m	to 3 m				
Trackscreen 11/4	TS11040	11 m	to 4 m	Surcharge for solid material		+ 25 %	+ 25 %
Trackscreen 11/5	TS11050	11 m	to 5 m				
Trackscreen 12/3	TS12030	12 m	to 3 m				
Trackscreen 12/4	TS12040	12 m	to 4 m	Extra Opening Post	335700		to 3 m
Trackscreen 12/5	TS12050	12 m	to 5 m	Extra Opening Post	335701		to 4 m
Trackscreen 13/3	TS13030	13 m	to 3 m	Extra Opening Post	335702		to 5 m
Trackscreen 13/4	TS13040	13 m	to 4 m				
Trackscreen 13/5	TS13050	13 m	to 5 m				
Trackscreen 14/3	TS14030	14 m	to 3 m				
Trackscreen 14/4	TS14040	14 m	to 4 m				
Trackscreen 14/5	TS14050	14 m	to 5 m				
Trackscreen 15/3	TS15030	15 m	to 3 m				
Trackscreen 15/4	TS15040	15 m	to 4 m				
Trackscreen 15/5	TS15050	15 m	to 5 m				
Trackscreen 16/3	TS16030	16 m	to 3 m				
Trackscreen 16/4	TS16040	16 m	to 4 m				
Trackscreen 16/5	TS16050	16 m	to 5 m				
Trackscreen 17/3	TS17030	17 m	to 3 m				
Trackscreen 17/4	TS17040	17 m	to 4 m				



When ordering please request opening bar left or right!
 Tracking under the beam – Option C
 Tracking in front of the beam – Option D

1. Netting fitments:

All Trackscreens have welded-in webbing straps (25 mm x 2000 kg). Strap quantity: qty 2 (2 m height), qty 3 (to 3 m height), qty 3 (to 4 m height), qty 4 (to 5 m height). The lower webbing strap ends 75 mm above the ground, the bottom flap is 35 cm. For opening doors up to 3 m height, 2 ratchets (50 mm x 5000 kg), and for doors over 3.10 m height, 3 ratchets, are installed on the free end.

2. Arrangement and installation:

Trackscreen can be made to any length and height. A later height adjustment is not possible.

Trackscreen can be installed to open to the left or to the right. Additional sliding post option allows access from both ends.

The pushed-back trackscreen takes up about 10 % of the total opening (e.g., for a curtain length of 12.0 m, the pushed-back trackscreen takes about 1.2 m, leaving an opening of 10.8 m).

3. Checking the installation site:

Ensure that there are no obstructions (e.g., rain gutters, drain pipes, posts) since the trackscreen folds up to approx. 50 cm on the inside and outside. Ensure that there is sufficient room on the opening end to attach the 50 mm tensioning ratchets (a minimum of 36 cm). Ensure that there is sufficient room on the fixed end to attach the 25 mm ratchets (a minimum of 20 cm).

4. Establishing the dimensions

1. Measure width A – clear opening dimension – for widths under a full metre take the next complete metre, the width of the net can be reduced on site.
2. Measure height B - clear opening dimension – for heights between full metres take the next largest height, when ordering, the exact height must be given – it is not possible to shorten it later.
3. Necessary information:
 Tracking under the beam – Option C
 Tracking in front of the beam – Option D
4. The tracking must definitely be horizontal.

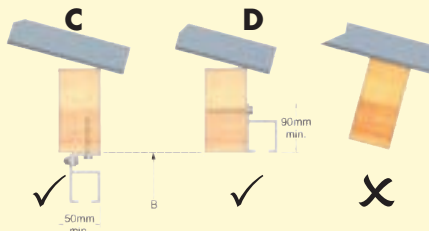

5. Colour

Special mesh available in green, blue, beige, grey, brown and black at no extra charge

The mesh width can be cut to size on site, but the height must be correctly stated in the order



Maxidoor – ideal for large openings and doors

For an operational width up to 20 m the door folds from the bottom up. It operates between two building IPE-beams (right and left boundaries of the doors). The Maxidoor is an economical solution for wide openings in stables and barns. The total opening width will be retained. Heights up to 9.1 m are possible, the clearance (access) height is reduced by 20 %. Electrical and manual version available.



The Maxidoor allows the complete building front to be accessible. Ideal for straw and grain storage



Wind protection – Maxidoor provides optimum interior light and climate conditions

<p>Maxidoor - manual</p>	<p>Maxidoor – electric drive (8 s/m) with counterweights and safety edge kit</p>	<p>300 mm</p> <p>The guide rollers are pulled from bottom to top thereby folding the Maxidoor together</p> <p>The guide rollers run in vertical guides e.g. IPE-beams or U-profiles (min. 70 x 110 mm inside dimension)</p>
--------------------------	--	---

Type	Ref.	Width	Height	Type	Ref.	Width	Height
Maxidoor 8/5.1	Y8051	8 m	5.1 m	Maxidoor 17/4.1	Y17041	17.0 m	4.1 m
Maxidoor 8/6.1	Y8061	8 m	6.1 m	Maxidoor 17/5.1	Y17051	17.0 m	5.1 m
Maxidoor 8/7.1	Y8071	8 m	7.1 m	Maxidoor 17/6.1	Y17061	17.0 m	6.1 m
Maxidoor 8/8.1	Y8081	8 m	8.1 m	Maxidoor 17/7.1	Y17071	17.0 m	7.1 m
Maxidoor 8/9.1	Y8091	8 m	9.1 m	Maxidoor 17/8.1	Y17081	17.0 m	8.1 m
Maxidoor 9.1/4.1	Y9141	9.1 m	4.1 m	Maxidoor 17/9.1	Y17091	17.0 m	9.1 m
Maxidoor 9.1/5.1	Y9151	9.1 m	5.1 m	Maxidoor 18.3/4.1	Y18341	18.3 m	4.1 m
Maxidoor 9.1/6.1	Y9161	9.1 m	6.1 m	Maxidoor 18.3/5.1	Y18351	18.3 m	5.1 m
Maxidoor 9.1/7.1	Y9171	9.1 m	7.1 m	Maxidoor 18.3/6.1	Y18361	18.3 m	6.1 m
Maxidoor 9.1/8.1	Y9181	9.1 m	8.1 m	Maxidoor 18.3/7.1	Y18371	18.3 m	7.1 m
Maxidoor 9.1/9.1	Y9191	9.1 m	9.1 m	Maxidoor 18.3/8.1	Y18381	18.3 m	8.1 m
Maxidoor 10/4.1	Y10041	10 m	4.1 m	Maxidoor 18.3/9.1	Y18391	18.3 m	9.1 m
Maxidoor 10/5.1	Y10051	10 m	5.1 m	Maxidoor 19/4.1	Y19041	19 m	4.1 m
Maxidoor 10/6.1	Y10061	10 m	6.1 m	Maxidoor 19/5.1	Y19051	19 m	5.1 m
Maxidoor 10/7.1	Y10071	10 m	7.1 m	Maxidoor 19/6.1	Y19061	19 m	6.1 m
Maxidoor 10/8.1	Y10081	10 m	8.1 m	Maxidoor 19/7.1	Y19071	19 m	7.1 m
Maxidoor 10/9.1	Y10091	10 m	9.1 m	Maxidoor 19/8.1	Y19081	19 m	8.1 m
Maxidoor 11/4.1	Y11041	11 m	4.1 m	Maxidoor 19/9.1	Y19091	19 m	9.1 m
Maxidoor 11/5.1	Y11051	11 m	5.1 m	Maxidoor 20/4.1	Y20041	20 m	4.1 m
Maxidoor 11/6.1	Y11061	11 m	6.1 m	Maxidoor 20/5.1	Y20051	20 m	5.1 m
Maxidoor 11/7.1	Y11071	11 m	7.1 m	Maxidoor 20/6.1	Y20061	20 m	6.1 m
Maxidoor 11/8.1	Y11081	11 m	8.1 m	Maxidoor 20/7.1	Y20071	20 m	7.1 m
Maxidoor 11/9.1	Y11091	11 m	9.1 m	Maxidoor 20/8.1	Y20081	20 m	8.1 m
Maxidoor 12.2/4.1	Y12241	12.2 m	4.1 m	Maxidoor 20/9.1	Y20091	20 m	9.1 m
Maxidoor 12.2/5.1	Y12251	12.2 m	5.1 m	Electric Motor 230 V	506010		
Maxidoor 12.2/6.1	Y12261	12.2 m	6.1 m	Electric Motor 400 V	506020		
Maxidoor 12.2/7.1	Y12271	12.2 m	7.1 m	Surcharge for high performance mesh			
Maxidoor 12.2/8.1	Y12281	12.2 m	8.1 m	Surcharge for solid material			
Maxidoor 12.2/9.1	Y12291	12.2 m	9.1 m				
Maxidoor 13.7/4.1	Y13741	13.7 m	4.1 m				
Maxidoor 13.7/5.1	Y13751	13.7 m	5.1 m				
Maxidoor 13.7/6.1	Y13761	13.7 m	6.1 m				
Maxidoor 13.7/7.1	Y13771	13.7 m	7.1 m				
Maxidoor 13.7/8.1	Y13781	13.7 m	8.1 m				
Maxidoor 13.7/9.1	Y13791	13.7 m	9.1 m				
Maxidoor 15.2/4.1	Y15241	15.2 m	4.1 m				
Maxidoor 15.2/5.1	Y15251	15.2 m	5.1 m				
Maxidoor 15.2/6.1	Y15261	15.2 m	6.1 m				
Maxidoor 15.2/7.1	Y15271	15.2 m	7.1 m				
Maxidoor 15.2/8.1	Y15281	15.2 m	8.1 m				
Maxidoor 15.2/9.1	Y15291	15.2 m	9.1 m				
Maxidoor 16.1/4.1	Y16141	16.1 m	4.1 m				
Maxidoor 16.1/5.1	Y16151	16.1 m	5.1 m				
Maxidoor 16.1/6.1	Y16161	16.1 m	6.1 m				
Maxidoor 16.1/7.1	Y16171	16.1 m	7.1 m				
Maxidoor 16.1/8.1	Y16181	16.1 m	8.1 m				
Maxidoor 16.1/9.1	Y16191	16.1 m	9.1 m				

Please indicate the clear opening dimensions in your order, because the system will be a custom manufacture.



Smaller sizes possible upon request. Please ask for a detailed offer.

Colour

Special mesh available in green, blue, beige, grey, brown and black at no extra charge



Variable Side Ventilation - Multibay Access

PATURA provides a variety of different ventilation systems to meet your requirements. They are suitable for intensively used cattle barns, calf barns as well as machinery buildings.

In warm or hot conditions, the systems can be opened to maximise air flow and ventilation. Different ventilation requirements can be covered with different systems. Opening from bottom to top, from top to bottom (VVS) as well as in both directions (VVS movable). This ventilations system is a modular system, that means it is absolutely your choice which is optimal. It is important to pay attention to local requirements and mounting possibilities as well as wind load and control options. VVS systems can be used for simple low-budget manually operated installations up to fully automated weather controlled multi-curtain multi-building applications. The type and design of the wind protection and side boxes can also be freely selected.

Please feel free to contact PATURA for all queries to find your suitable system. We would be pleased to assist you to get the best model for you and your needs.

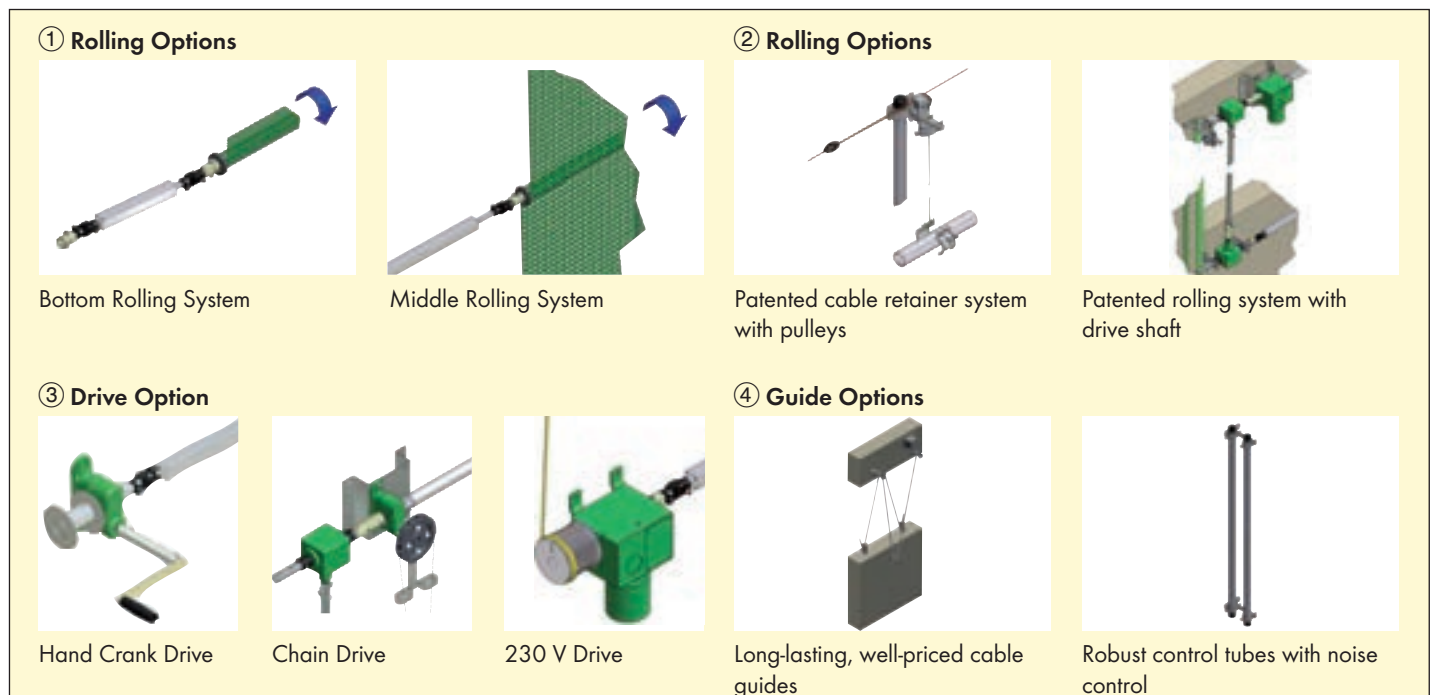
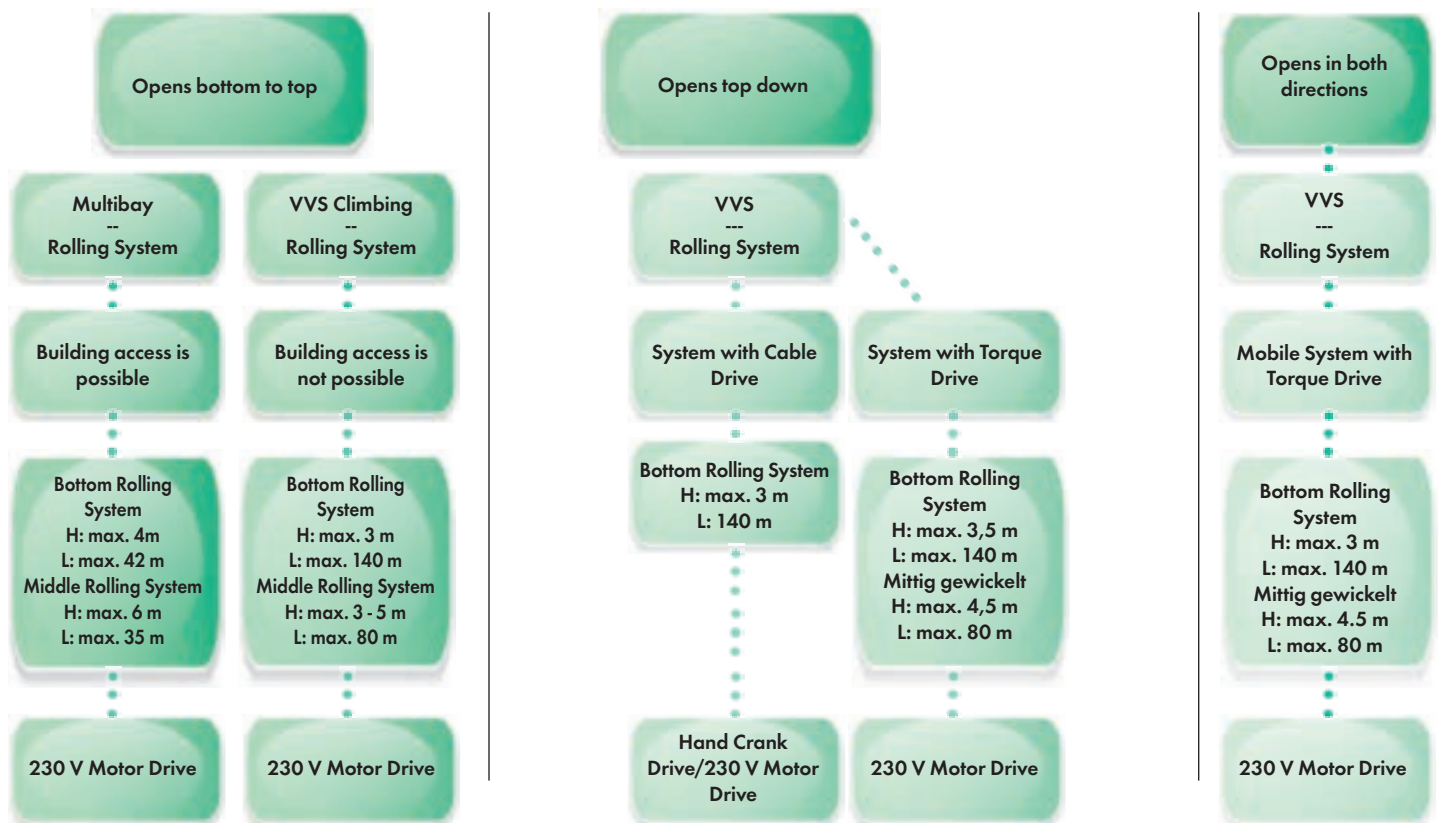



The side ventilation systems are ideal to get free building access

The variable side ventilation systems are ideal for calf and dairy barns or storage buildings which in summer with completely raised wind screen offers optimum air flow and easy access. The screen is rolled up above so that beneath there is free building access at the front. Additional locking catches provide for fast and secure locking even with high winds.

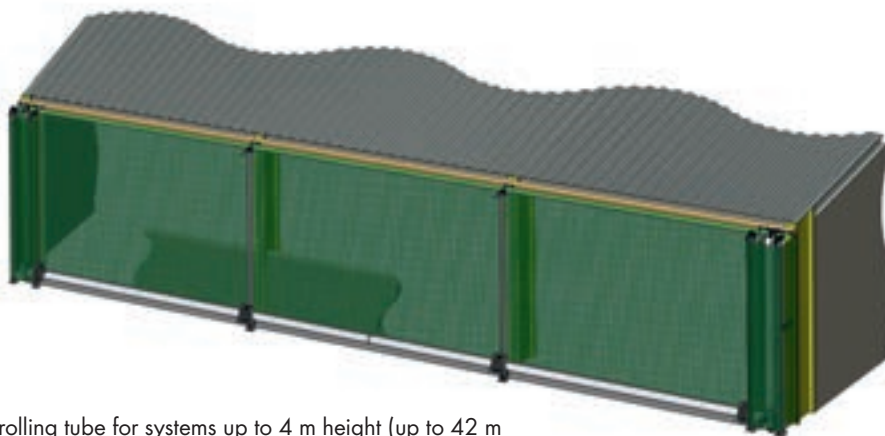

Middle rolling tube for systems up to 4 m height (up to 42 m length) and 70 m length (up to 1 m height)

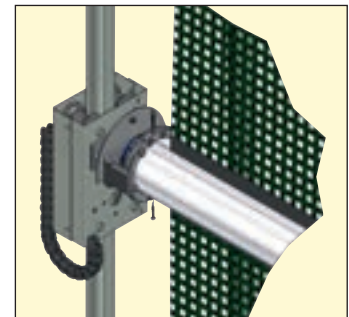

Middle rolling tube for systems of 4.1 m height (up to 39 m length) to 6 m height (up to 35 m length)

Important dimensions

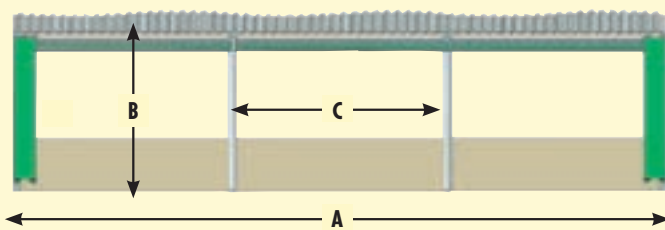

1. Dimensions (see above)

- A = building length
- B = height: top of opening – floor / bottom of opening
- C = building bay width

2. Material selection - screen

- Farmflex
- High performance mesh
- Solid material

3. Installation options – guide rails

- Top: on outside of building front – bottom: on outside of building front
- Top: on outside of building front – bottom: on the ground
- Trolley box on free end (option)

4. Drive options

- Electric drive with 230 V tubular motor and rotary switch with dead man control - 16 sec/m

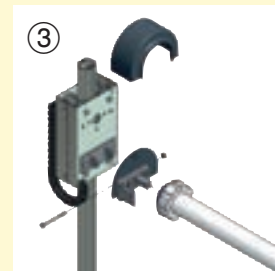
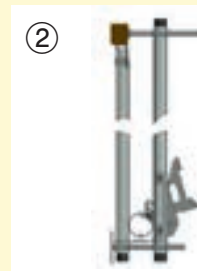

- ① New locking catch storm protection provides fast and secure locking
- ② Robust control tubes with noise control profil for a strong wind stability
- ③ Long lasting robust trolley box and tube motor with switch control

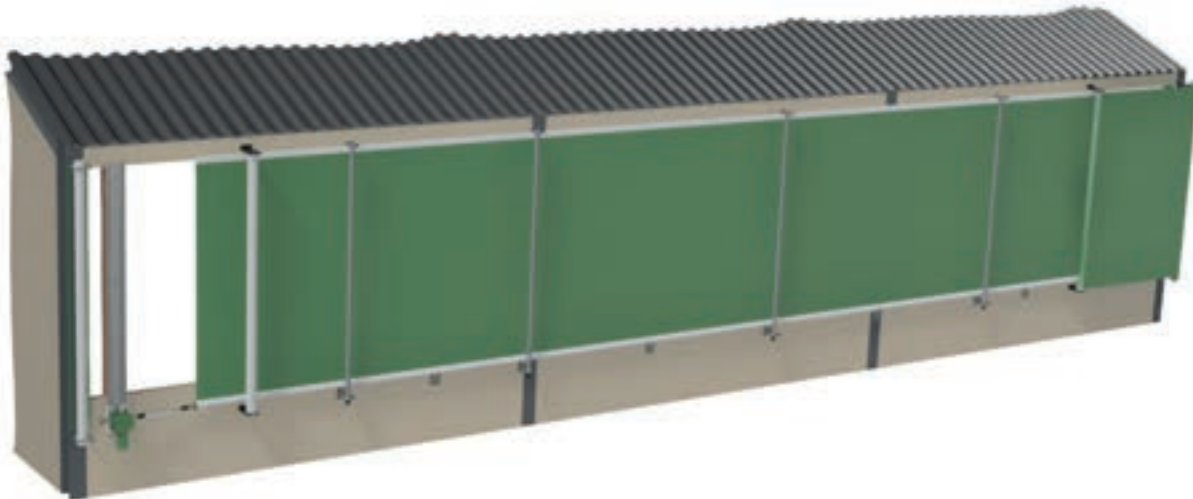

Multibay side ventilation system - complete opening from bottom to top

The side ventilation systems are ideal for calf and dairy barns or storage buildings. In summer, they provide an optimum air flow and easy access when the wind screens are completely raised. The screen is rolled up above so that beneath there is free building access at the front. Strong guide rails offer high stability even with strong wind conditions.



Durable electric motor drive



Solid guide rail for electric drive

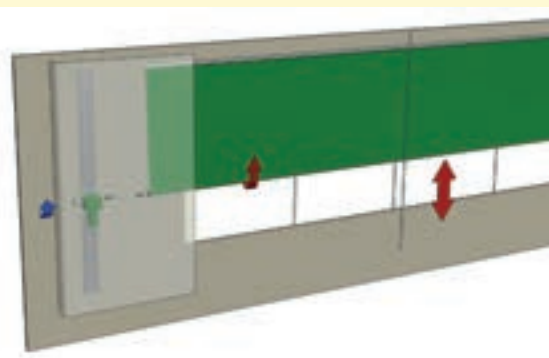

Bottom rolling tube for systems up to 3 m (length max. 140 m) and middle rolling tube for systems from 3 to 5 m height (length max. 80 m)



Important dimensions

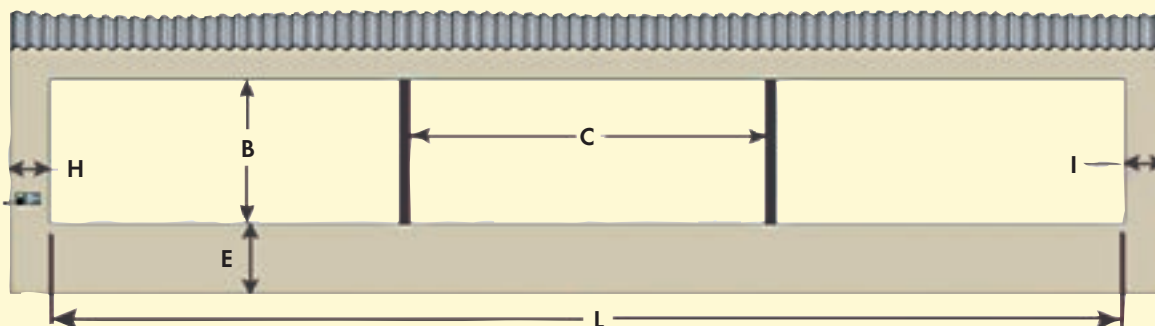

1. Dimensions (see above)

- L = length of opening (max. 140 m)
- B = height of opening (max. 5.0 m)
- E = height of low wall (min. 0.8 m)
- C = building bay width (max. 6 m)
- H = installation space - drive side (max. 1.70 m)
- I = installation space - free end (min. 1.70 m)

2. Material selection - curtain

- Special Mesh
- High Performance Mesh
- Solid Material

3. Installation options – guide rails

- Top and bottom: on outside of building front

4. Drive options

- 230 V motor drive with rotary switch



Variable Side Ventilation "Breeze" - the entry-level model

The variable side ventilation system "Breeze" is suitable for creating inexpensive, side ventilation systems for stables. It is a cable-driven winding system that opens from top to bottom. Excess material is rolled up at the bottom. The pillars of the building are used as wind protection on the inside and either profile pipes or polyester ropes on the outside. A high-quality, durable PVC tarpaulin provides wind protection. A maximum height of 3.00 m is possible. It can be driven manually (crank/chain drive) or electrically (230 volts). The electric motor is controlled with the help of a switch or with an air conditioning control unit, which is equipped with sensors for wind, rain and temperature.

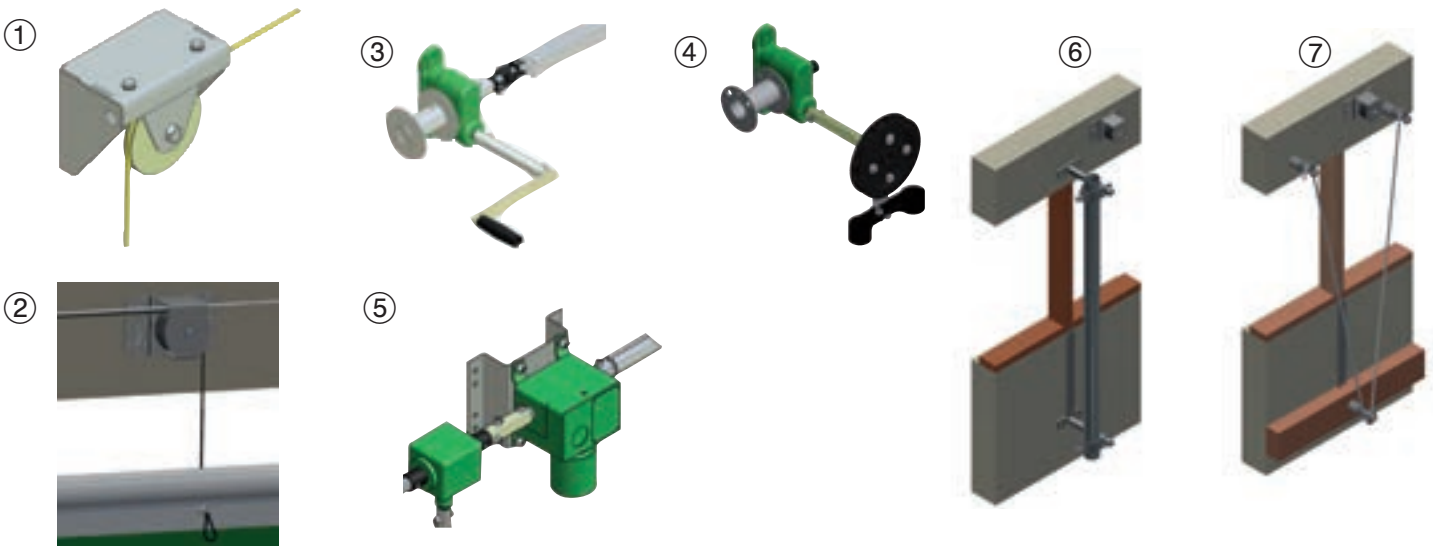

Guide elements

- ① Cable driven with massive pulley
- ② Robust, easy to assemble Pulley for field ropes

Drive components

- ③ Hand Crank Drive
- ④ Chain Drive
- ⑤ 230 V Drive

Guide options

- ⑥ Inside: Existing building structure (Wood/metal)
- ⑦ Outside: profil tubes with protective profile or polyester rope

1. Dimensions (see left)
 A = building length
 B = height: top of opening - floor
 B1 = height of opening

C = building bay width
 D = height: top of building - floor

2. Material - screen

- Cover high performance mesh
- Solid material

3. Installation options – guide rails

- Top: on outside of building front
- Bottom: on outside of building front

4. Drive options

- Motor drive or manual drive
- Weather station options

VVS with Cable Drive

The upper tube is moved upwards or downwards. This happens via vertical cables which are fastened to a horizontal drive shaft that proceeds the complete length.

Bottom rolling system for up to 3 m height and up to 70 m length (motor at one end) or 140 m length (middle motor)

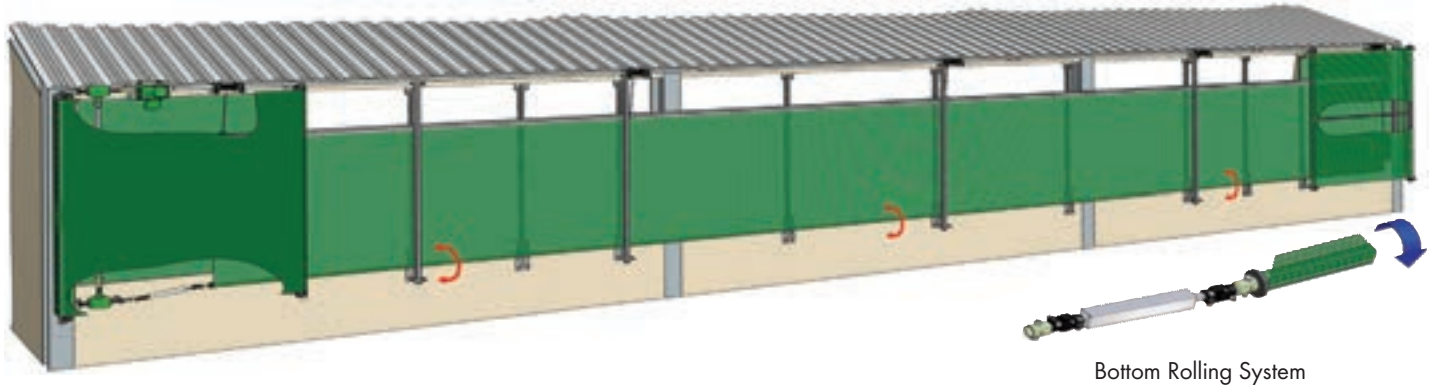

Bottom Rolling System

VVS with Torque Drive

The upper tube is moved upward or downward via vertical wire ropes which are fastened to a horizontal drive shaft that proceeds the complete length. It opens from top to the bottom. The screen then is rolled up on the bottom rolling tube.

Bottom rolling system for up to 3.5 m height and up to 70 m length (motor at one end) or up to 140 m length (middle motor)

Middle rolling system from 3.5 to 5.0 m height and up to 40 m length (motor at one end) or up to 80 m length (middle motor)



Bottom Rolling System

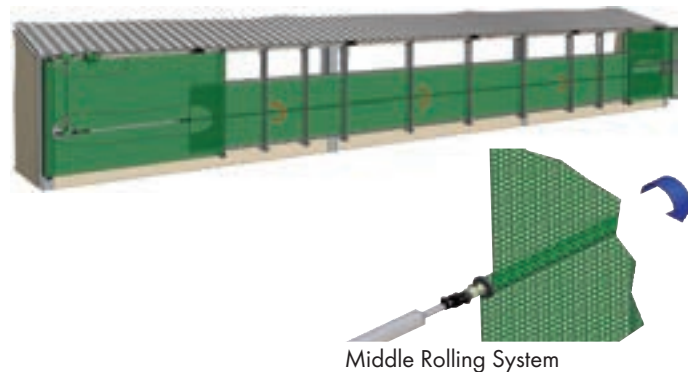

Middle Rolling System

VVS with torque drive and movable motor

The variable side ventilation system for all weather conditions. A movable motor allows to choose various ventilation options: open top - closed bottom, closed top - open bottom, open top - open bottom. This system can be opened or closed in order to achieve optimum weather protection and housing conditions. Besides that, in sunny conditions it can be used for shading options.

The upper tube is moved upward or downward via vertical wire ropes which are fastened to a horizontal drive shaft that proceeds the complete length. The screen then is rolled up on the bottom rolling tube (up to 3 m height) or on the middle rolling tube (from 3.00 m height).

Movable drive provides more ventilation and shading options

Bottom rolling tube systems up to 3 m height and up to 140 m length.
Middle rolling tube systems for heights 3.0 - 4.5 m and up to 80 m length.

Bottom Rolling System



Possible System Components

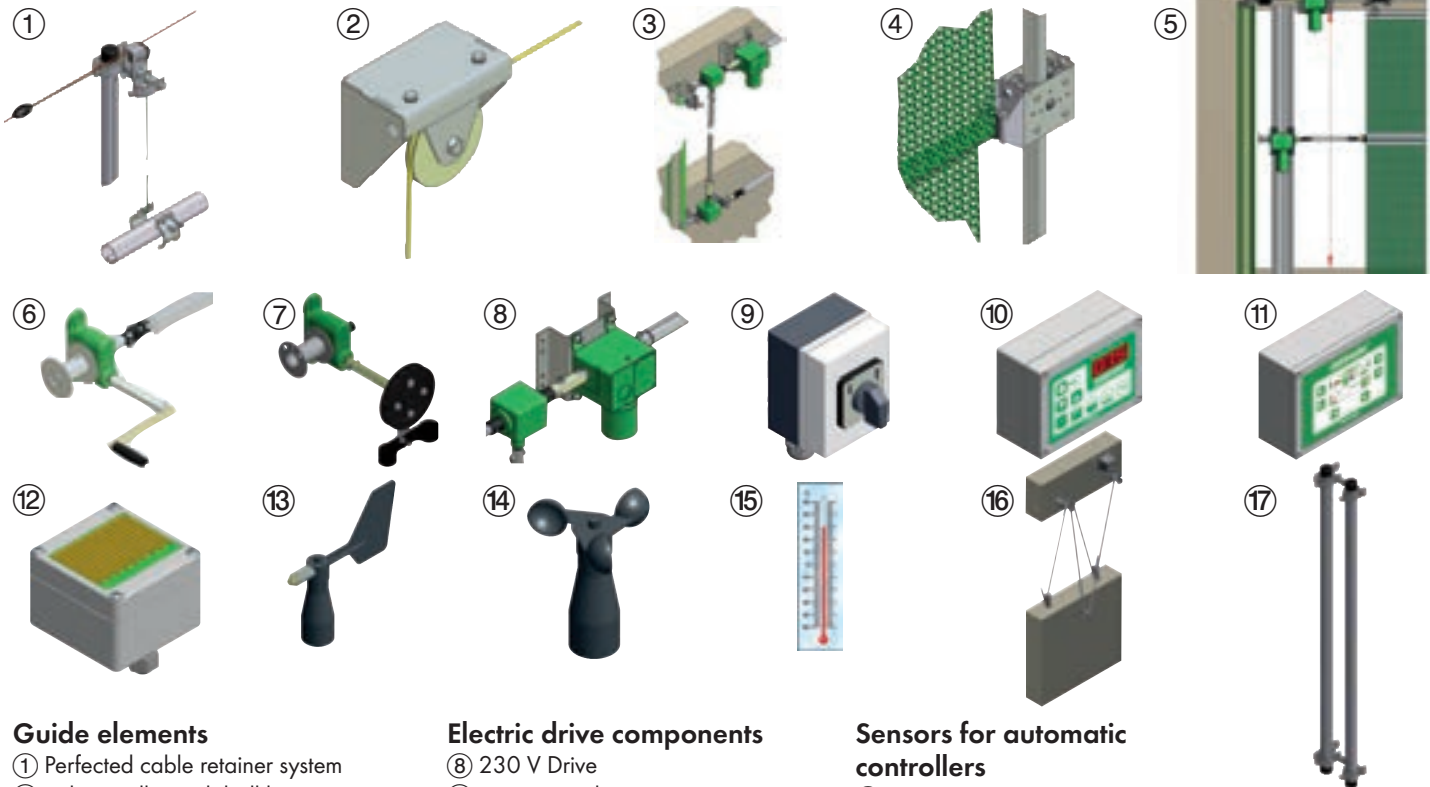

Guide elements

- ① Perfected cable retainer system
- ② Robust pulley with ball bearing
- ③ Durable angle gears
- ④ Trolley box for middle rolling system
- ⑤ Robust guide rail for movable system

Manual

Drive components

- ⑥ Hand Crank Drive
- ⑦ Chain Drive

Electric drive components

- ⑧ 230 V Drive
- ⑨ Rotary switch
- ⑩ Control V10 with Proportional Switch (predefined opening positions)
- ⑪ Control Unit V40 (temperature/rain/wind)

Sensors for automatic controllers

- ⑫ Rain Sensor
- ⑬ Wind Direction Sensor
- ⑭ Wind Speed Sensor
- ⑮ Temperature Sensor

Guide Options

- ⑯ Durable plastic guide ropes
- ⑰ Robust control tubes with noise control

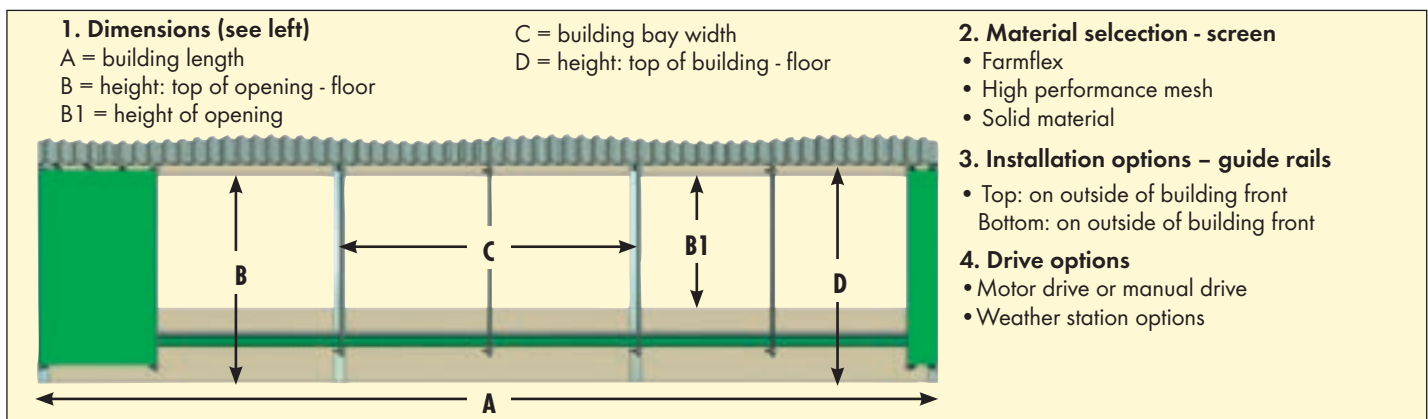

A breath of fresh air for your barn and your herd

PATURA always strives to improve the air quality in agricultural buildings. When we are able to reduce the heat that animals are exposed to, we can raise their performance to better profits. Therefore maintaining fresh air throughout the facility is key. Air exchange and ventilation can be improved by using one or a combination of the following methods: Natural ventilation - using side wall inlets in combination with a roof outlet, or mechanical ventilation - using fans and air tubes.

Since the requirements for the ventilation tubes differ considerably depending on the species, PATURA has decided on two different systems. More sensitive groups of animals, such as calves, require a rather even draught-free air supply, while cows also need a cooling effect, especially in summer.

While the air speed for calves should be 0.25 - 0.28 m/s, we need much higher values (4.0 m/s) for the "cooling variant". The air exchange rate per hour is also much higher for large livestock. This requires much larger tube diameters and more powerful fans. The Vent-Tube-System "Cool" was developed exactly for this application area.

VentTube-System offers:

No draught

Evenly distributed clean fresh air

Homogenous air distribution

For calves

Your advantages:

Advantage 1:	Constant and clean fresh air to the animals without creating a draught
Advantage 2:	Reduced bacterial pressure
Advantage 3:	Reduction of respiratory problems
Advantage 4:	Reduction of medication consumption
Advantage 5:	Reduction of veterinary costs
Advantage 6:	Complete system, adapted to your needs and situation

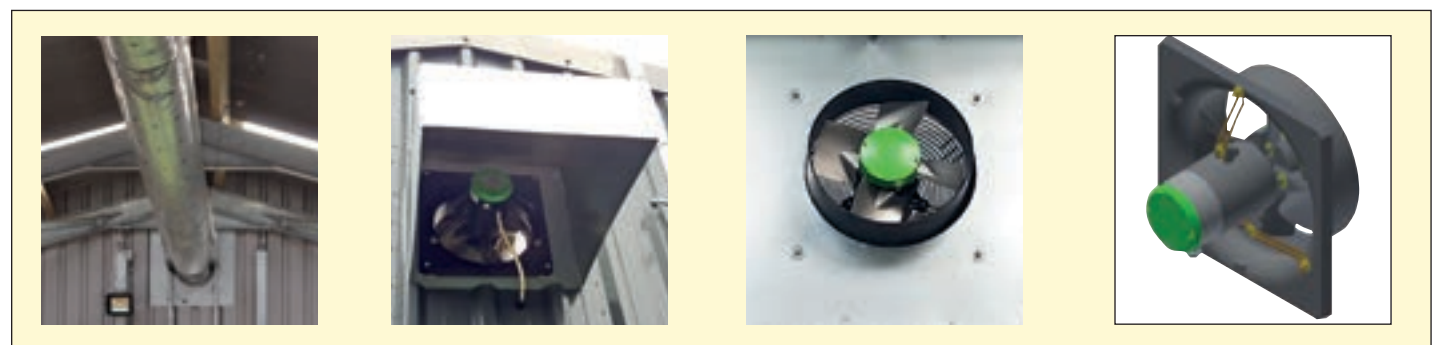

Components and operation:

A Vent-Tube consists of an outside mounted fan that is connected to a horizontally mounted fabric tube. This fabric tube is provided with air openings at strategic positions to allow evenly distributed clean fresh air to exit the tube along its length.

The diameter of the tube and the position and size of the openings are crucial factors in providing an optimum fresh air-flow towards the animals. Microclimate improves since germinated air gets displaced and bacteria loads at the animals reduce. VentTube System is equally appropriate for individual boxes or group pens.



Vent-Tubes provide plenty of fresh, draught-free, equally dispersed air at animal level to remove moisture, gases, airborne pathogens and/or excess heat. This is the optimal environment to raise healthy and strong calves.

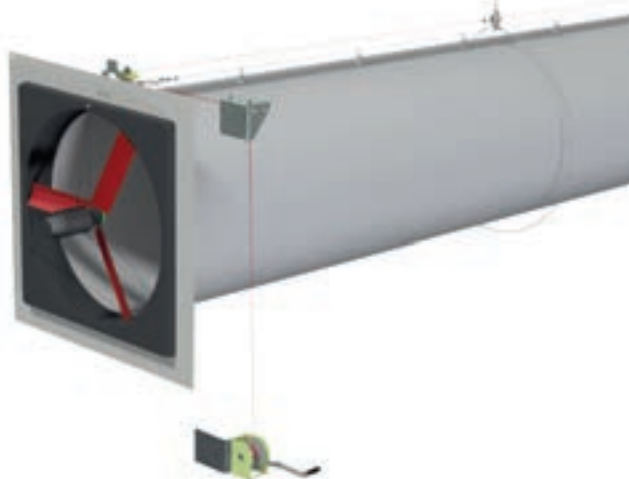

Our VentTube package consists of a fabric ventilation tube with suspensions and tensioning ropes, a fan with suction box and a metal cover. With VentTube Cool the system can be lifted up by a lifting device when not in use (optional).



Please send us some pictures and a sketch of your particular on-site situation. We would be glad to send you a quote without any obligation.



With rounded edges!

PVC Strip Doors – protection from wind, cold and flies

The decisive advantages

- Ideal protection from wind and cold, while still offering optimum access
- Reduces flies in summer
- Ideal for boxes and stall with outside areas
- Suitable for doors, gates and entrances
- Manufactured from 3 mm thick PVC
- Rounded edges, therefore no danger of injury
- Transparent for optimum visibility and light conditions
- Fixture material for front and support installation available

Calculation example (front mounting)

Door opening: 2.50 m wide, 2.50 m high:

30 cm wide strips, 9 cm overlap

Width covered: 30 cm - 9 cm = 21 cm

2.5 m (door width) : 0.21 m (width covered) = 11.9 strips
Round up = 12 strips

12 strips x 2.55 m length (height + 5 cm) = 30.6 m
Round up = 31 m

3 installation variants

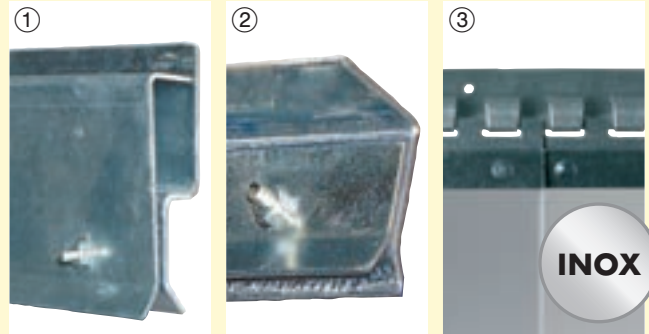

- ① Front mounting: inside or outside a door lintel
- ② Lower mounting: underneath a door lintel
- ③ Swing mounting: inside or outside a door lintel, swinging suspension, ideal for low entrances
Do not mount in the area of the manure slider!

Stockshade – shady places for outdoor animals

In recent years a trend has been to rear livestock and poultry outside. Outside, the animals need, above all, protection from excessive sun. Stockshade offers optimum protection from excessive sun, thus leading to an animal-friendly micro-climate in the shaded area.



Stockshade e.g., for open farming of pigs, also suitable for cattle, sheep, horses and outdoor poultry

Type	Ref.	Size	Description
PVC Strip 300 x 3 mm Blue translucent, suitable up to -20° C	503030	per metre	
PVC Strip 300 x 3 mm Blue translucent, suitable up to -20° C	503032	25 m roll	
PVC Strip 300 x 3 mm Blue translucent, suitable up to -20° C	503035	50 m roll	
PVC Strip Compact 300 x 3 mm Green translucent, suitable up to -15° C	503041	25 m roll	
PVC Strip Compact 300 x 3 mm Green translucent, suitable up to -15° C	503042	50 m roll	



① Clamp Bar, front mounting	503101	1.15 m
① Clamp Bar, front mounting	503102	2.20 m
① Clamp Bar, front mounting	503103	2 x 1.6 m

② Clamp Bar, lower-mounting	503111	0.93 m
② Clamp Bar, lower-mounting	503112	1.98 m
② Clamp Bar, lower-mounting	503113	3.00 m

③ Pendular Rail, made completely of stainless steel 503120 Incl. 5 swing plates of 30 cm width Overlapping: 4.1 / 8.2 / 12.3 cm	0.98 m
③ Pendular Rail, made completely of stainless steel 503121 Incl. 7 swing plates of 30 cm width Overlapping: 4.1 / 8.2 / 12.3 cm	1.23 m
③ Pendular Rail, made completely of stainless steel 503122 Incl. 11 swing plates of 30 cm width Overlapping: 4.1 / 8.2 / 12.3 cm	1.97 m



- For closing of door openings, while still allowing unhindered animal transit
- UV-stabilised, transparent, 3 mm thick PVC
- In winter wind and cold are kept away, in summer flies are kept out
- Strips installed with 4.1 cm to 15 cm overlap
- 3 different, galvanised mountings:
 - 1: Installed inside or outside the lintel (pre-drilled holes for 9 cm overlap)
 - 2: Installed under the lintel (pre-drilled holes for 9 cm overlap)
 - 3: Swing mounting (specially for low entrances)

Stockshade 4.5 x 4 m	335800
Stockshade 6 x 4 m	335801

- For shading areas/places for all animal species
- Made of UV-stabilised HD polyester, 75 % shade
- Belts strips and elastic attachment loops

Ideal for outdoor rearing



Mounting example

